



1946

CUTTING  
EQUIPMENT

2015 general catalogue

**Rasor Elettromeccanica S.r.l.**

Via Vincenzo Caldesi 6  
20161 Milan, Italy

**Phone**

(+39) 02 662 21 231

**Fax**

(+39) 02 662 21 293

**Email**

info@rasor-cutters.com

**[www.rasor-cutters.com](http://www.rasor-cutters.com)**





1946

---

# CUTTING EQUIPMENT





*As of today Rasor Elettromeccanica Srl boast the professional continuity of three generation yet with the strong support by the founder thanks to his passion, devotion and now hundred years old experience.*





# ABOUT US



Rasor Elettromeccanica Srl was born in Milan in 1946 by founder Mr. Luigi Spinelli with his inborn talent in technical and precision mechanics matters and exceptional ability successfully realized the first wholly hand-made bench cutter.

Rasor's products were firstly born for the application in textile industry while now the range has been enlarged to industries for technical textile and composite material production.

The distinctiveness of Rasor is the wholly inside work to start with design of the product, production, packaging, delivery. All thanks to workers professionally grown up together with the Company being in perfect agreement with the founder with the sole target to grant quality of each single produced cutter.

That is still the key point of Rasor and so to be daily engaged with any improvement and open to study and develop new materials and technologies.

Rasor boast an international network of distributors to be successfully present on all the Continents.



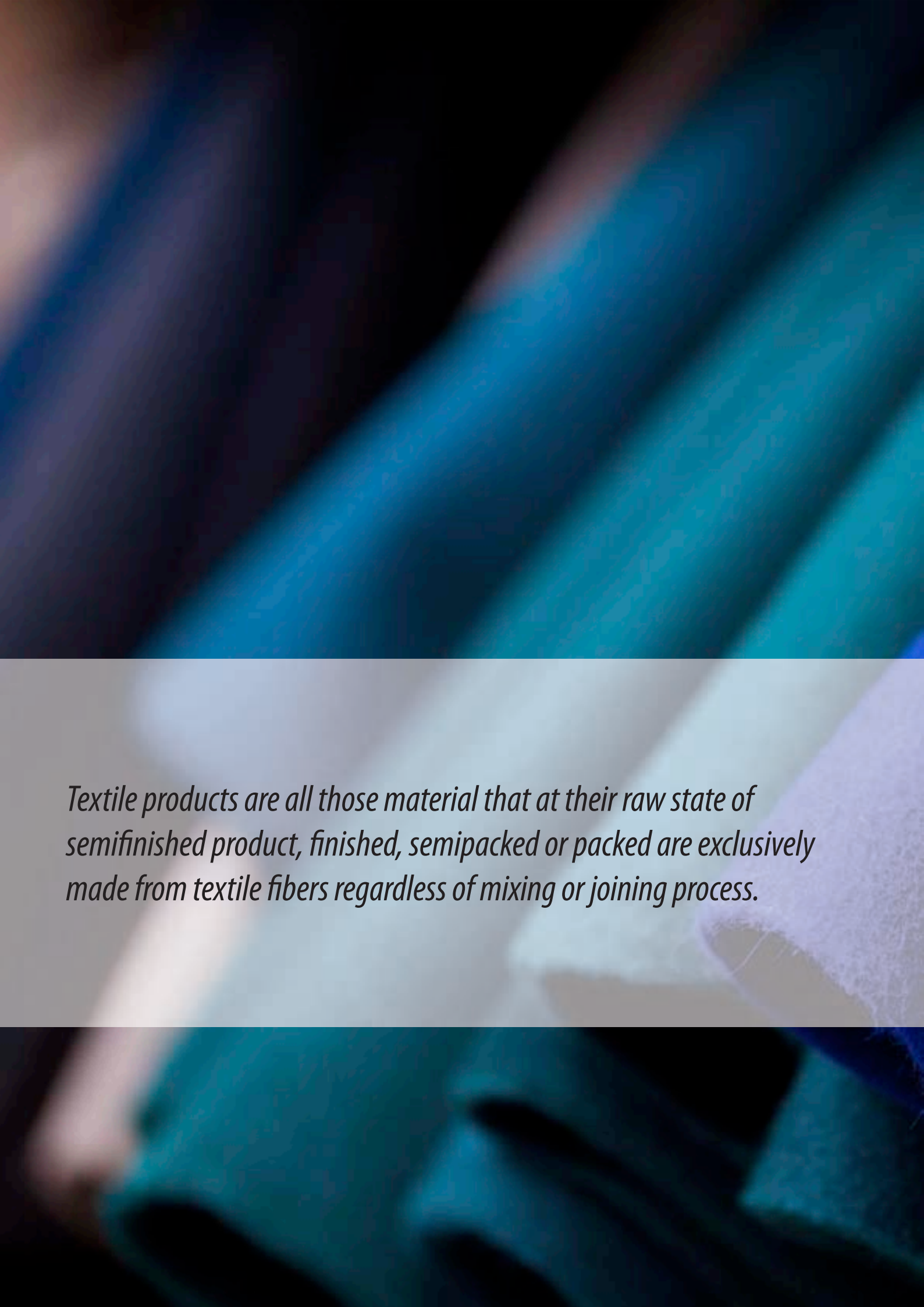

*Textile products are all those material that at their raw state of semifinished product, finished, semipacked or packed are exclusively made from textile fibers regardless of mixing or joining process.*





# TEXTILE



In 1946 Razor produce the first bench cutters for the cloth industry, leather industry and furniture industry.

For 60 years over 30000 units have been sold all over the world to textile laboratories and tannery.

The engagement of Razor for the textile industry go forward with the introduction of cutters more and more versatile, light and step by step with the progress of technology and design.





A close-up, black and white photograph of a car seat. The seat is upholstered in a textured material, likely leather or a high-quality synthetic material, with prominent white stitching along the seams. The texture of the material is clearly visible, showing a fine, pebbled grain. The lighting is soft, highlighting the contours and the texture of the fabric. The background is slightly blurred, focusing attention on the seat's details.

*A technic fabric is a fabric not produced for appearance purpose but for fabric feature itself. The application field of technic fabric is rapidly growing up also as support of a wide range of many other industrial fields.*



# TECHNICAL TEXTILE



The world growing rate of technic fabric production is about 4%/year compared with the growing of typical fabrics. The importance of development of technic fabric materials is on an equal footing with the industry's more and more requirements.

As of today the relatively most common technic fabric materials are applied in the following fields:

Agrotech, Mobiltech, Buildtech, Clothtech, Geotech, Hometech, Mobiltech, Oekotech, Packtech, Sporttech

In the latest years Razor have developed technologies and experience to satisfy any requirement to cut technic fabrics with over 10 models within their range of electrical or pneumatic, hand-held or OEM cutting units.







*The composite material is basically a material made of combination of more different simple materials. The ensemble of all the simple materials make a product able to guarantee very high mechanical properties with very low expansion of mass. This is why the composite material are widely used in application where key point is lightness.*

# COMPOSITE



The composite material are required in production fields where it is necessary to satisfy the need to keep light weight with high mechanical properties.

Particularly the aerospace, naval and automotive industries widely use composite material for the construction of wings structures, fuselages, trailers, boats, canoes, cars' panels, frames for Formula One cars, springs, engine parts and other accessories. The aerospace and warlike industries use composite material respectively for construction of components for space station and space vehicles and for construction of helmet and bullet-proof vest.

In the sport filed the composite material are applied for the construction of skies, bob-sleds, tennis rackets, bicycles, fishing rods, risers for archery and sticks for the high jump.

In medical field the composite material are applied for construction of prosthesis while in the plant construction composite material are used for pipes and tanks construction.

In the latest five years Rasor has focused their know-how and experience in the development of cutting tools especially made for composite material cut. Most of the many producers/ end users of composite material have standardized Rasor tools for their cutting process.



# MODELS & APPLICATIONS





	TEXTILE	TECHNICAL TEXTILE	COMPOSITE		TEXTILE	TECHNICAL TEXTILE	COMPOSITE
<b>Battery Driven Scissors</b>				<b>SinglePhase Cutting Units</b>			
<b>Zero702</b> (pag. 15)	•	•	•	<b>D86PS</b> (pag. 53)	•	•	
<b>Electric Hand Shears</b>				<b>SW100S</b> (pag. 54)	•	•	
<b>DS503</b> (pag. 19)	•	•		<b>SW10SS</b> (pag. 55)	•	•	
<b>DS503MT</b> (pag. 20)	•	•		<b>SW12S</b> (pag. 56)	•	•	
<b>OPTIMA 702</b> (pag. 21)	•	•	•	<b>SW12SSX</b> (pag. 57)	•	•	
<b>Pneumatic Hand Shears</b>				<b>SW12SM</b> (pag. 58)	•	•	•
<b>FP503</b> (pag. 25)	•	•		<b>SW12SSM</b> (pag. 59)	•	•	•
<b>FP503MT</b> (pag. 26)	•	•	•	<b>3-phases Cutting Units</b>			
<b>FP70</b> (pag. 27)	•	•		<b>GRT86</b> (pag. 63)	•	•	
<b>FP861</b> (pag. 28)	•	•		<b>GRT86V</b> (pag. 64)	•	•	
<b>FP861MT</b> (pag. 29)			•	<b>GRT10</b> (pag. 65)	•	•	
<b>FP861RC</b> (pag. 30)	•			<b>GRT10SX</b> (pag. 66)	•	•	
<b>Electric Bench Cutters</b>				<b>GRT12</b> (pag. 67)	•	•	
<b>D86</b> (pag. 33)	•			<b>GRT12SX</b> (pag. 68)	•	•	
<b>D100</b> (pag. 34)	•			<b>GRT12M</b> (pag. 69)		•	•
<b>D86P</b> (pag. 35)	•	•		<b>GRT12SM</b> (pag. 70)		•	•
<b>SW100</b> (pag. 36)	•	•		<b>GRT12DT</b> (pag. 71)		•	•
<b>SW12</b> (pag. 37)	•	•		<b>3-phases DirectDrive Cutting Units</b>			
<b>SW12M</b> (pag. 38)		•	•	<b>DD120R</b> (pag. 75)	•	•	•
<b>Pneumatic Cutting Units</b>				<b>DD120L</b> (pag. 76)	•	•	•
<b>FP861V</b> (pag. 41)	•	•		<b>DD120RC</b> (pag. 77)	•		
<b>FP861A1</b> (pag. 42)	•	•		<b>DD120LC</b> (pag. 78)	•		
<b>FP100</b> (pag. 43)	•	•		<b>DD120DT</b> (pag. 79)	•	•	•
<b>FP100SX</b> (pag. 44)	•	•		<b>Accessories</b>			
<b>FP120</b> (pag. 45)	•	•	•	<b>BLADES &amp; MODELS</b> (pag. 82)			
<b>FP120SX</b> (pag. 46)	•	•	•	<b>BLADES</b> (pag. 84)			
<b>FP120M</b> (pag. 47)	•	•	•	<b>ACCESSORIES &amp; MODELS</b> (pag. 86)			
<b>FP120SM</b> (pag. 48)	•	•	•	<b>ACCESSORIES</b> (pag. 88)			
<b>FP120DT</b> (pag. 49)	•	•	•	<b>Dealers</b> (pag. 90)			



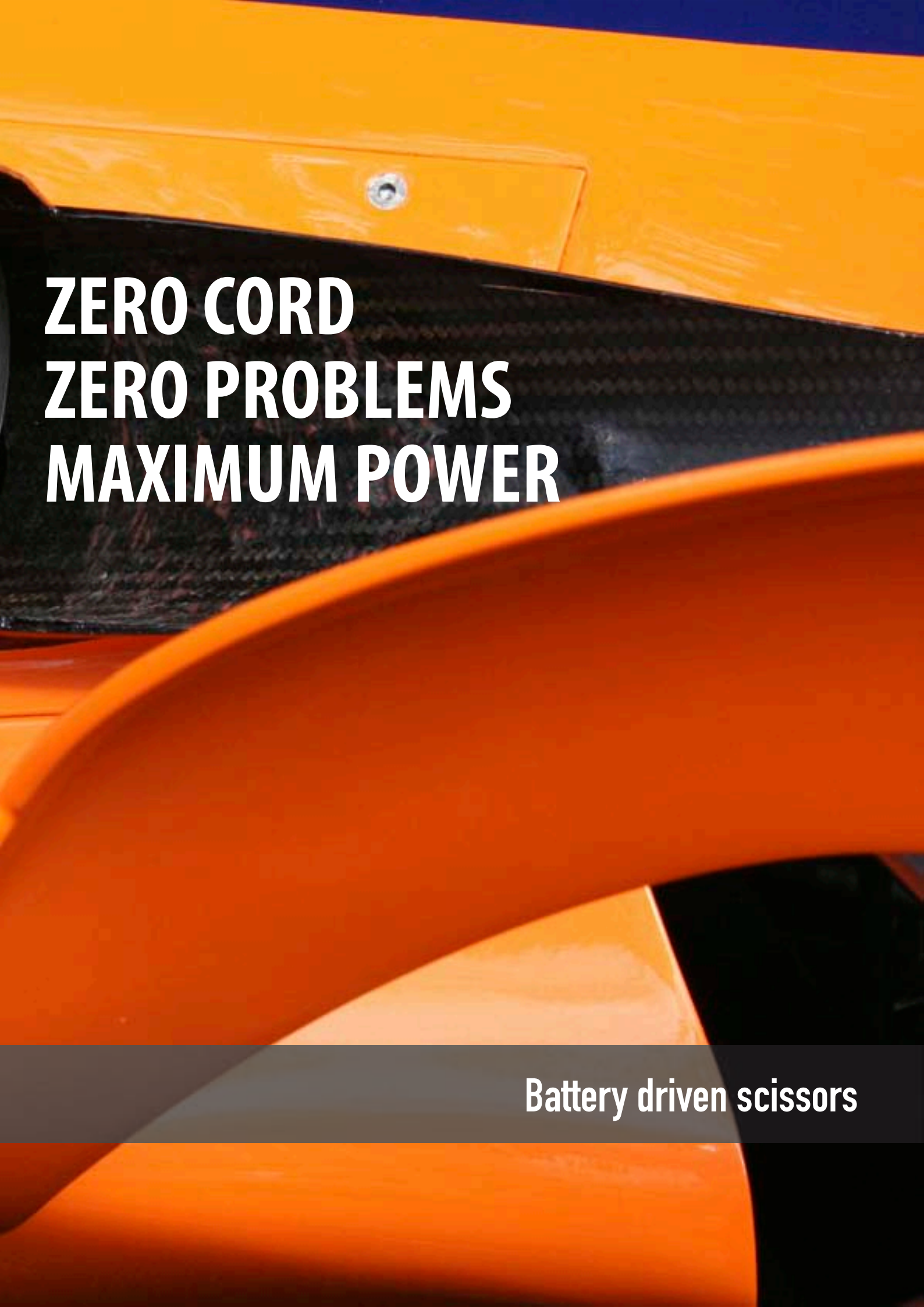

**ZERO CORD  
ZERO PROBLEMS  
MAXIMUM POWER**

**Battery driven scissors**





TEXTILE

TECHNICAL  
TEXTILE

COMPOSITE

# ZERO702

BATTERY DRIVEN SCISSORS



## SPECIFICATIONS

- Blade diameter:** 70 mm (2.75"), with hard metal counterblade
- Blade descr.:** 70SHSS, 4-edges, HSS steel
- Blade speed:** 600-1000 r.p.m., adjustable
- Cutting ability:** 18 mm (0.7")
- Power:** 18 V, 400 W
- Battery:** 18 V Li-Ion®, 3.0 Ah rechargeable with charge status indicator LED
- Recharging time:** 55 min. (with standard charger)
- Weight (with battery):** 1900 g
- Total weight (with packaging):** 4400 g
- Minimum brightness for working operations:** 200 LUX
- Vibrations at start up:** < 2.5 m/sec<sup>2</sup>
- Temperature range:** 0 – 55 C
- Umidity range:** 10 – 95% without condensate

Li-Ion® Technology



Speed regulator



## SAFETY

- High-adjustable transparent fore blade protection
- Fixed transparent back blade protection
- Thermic protection inside the battery

## DESCRIPTION

Zero702 is the newly born model at Rasor. The first hand-held battery driven cutting tool for professional and stepless production process. It is made as combination of the cutting body of the already approved OPTIMA 702 and the innovative and modern battery driven motor. It weighs only 1900 grams (battery included) and develop a power of 400Watt which combined with a bronze/steel coupling gear develop an impressive cutting power. Zero702 is able to cut any kind of material at the "soft" stage up to a maximum thickness of 18mm. This is why this model is widely applied in textile, technical fabrics or composite material fields. The high torque allows to cut even rubber materials and plastic base materials in the fields of carpets or floorings. The speed of the knife is adjustable electronically from 600 RPM to 1000 RPM in order to be suitable to cut any kind of material. The foot is steel made, strong and miniaturized so to allow to trim straight or curved portions very easily and precisely. The push button sharpening stone allows the sharpening of the knife edge to be done in less than 10 seconds without removing the knife. The new rear fixed knife protection is now transparent plastic made to give more visibility during the cut operations. The battery of latest generation is lithium ions technology so to be able to develop 3 Ah. It has an extraordinary life and it is possible to see the charging rate through a LED lamp. Through the standard charger the battery can be re-charged in 55 minutes while through the fast charger (option) battery can be re-charged in 30 minutes only. All these features make ZERO702 the battery hand-held cutting tool more revolutionary and powerful on the market able to satisfy any need in field of professional cutting tools.



## BLADES Ø 70 MM



## ACCESSORIES

- Grinders** SW1086DIA
- Batteries** BAT18
- Chargers** CH01, CH02
- Rail** G30-04
- Trailers** C30-04, C30-0401
- Stopper** S30-04
- Blocking Pins** F5057
- Butterfly Keys** F5059
- Gear Grease** T107900
- Metal Gloves** GMT-REV







**POWERFUL  
LIGHT  
EASY**

**Electric hand shears**





TEXTILE

TECHNICAL  
TEXTILE

COMPOSITE

# DS503

ELECTRIC HAND SHEARS



## SPECIFICATIONS

- Blade diameter:** 50 mm (1.96"), with hard metal counterblade
- Blade descr.:** 503EEXT, 6-edges, EXTRA steel
- Blade Speed:** 1300 r.p.m.
- Cutting ability:** 9 mm (0,35")
- Power:** singlephase – 90 W
- Max absorption:** 1 A, with fuse protection
- Net weight (with power supply cord):** 950 g
- Total weight (with packaging):** 1570 g
- Electric cable length:** 1.5 mt (extensible)
- Minimum brightness for working operations:** 200 LUX
- Vibrations at start up:** < 2.5 m/sec<sup>2</sup>
- Temperature range:** 0 – 55 C
- Umidity range:** 10 – 95% without condensate



## SAFETY

- Safety start/stop device system
- High-adjustable transparent fore blade protection
- 1 A cut-off fuse
- Double electric insulation

## DESCRIPTION

For over 30 years within the market, the model DS503 is the smallest, most powerful and professional electrical hand-held cutting machine Rasor have ever produced. The DS503 is the fifth upgrade in the DS series resulting in the 2014 model which reaches the highest level in technology and safety. It weighs only 950 grams and its ergonomic design combined with a 90Watt balanced and silenced motor make this model a unique cutting tool essential in all fields. A Reinforced body and bronze/steel gear coupling create a high torque which allows the use of this electrical shear not only in textile field but also in technical fabrics or leather fields. The maximum cutting thickness is now 9mm and the new push button sharpening stone allows the sharpening of the knife edge to be done in less than 10 seconds without removing the knife. The new circuit board includes a glass fuse which can be easily replaced without disassembling the shear and the new strong and slim shaped foot allows to trim curve sections very easily. The new model DS503 is truly a novel concentration of power and lightness in the field of professional cutting tools.



## BLADES Ø 50 MM



503EEXT

503EHSS

503DHSS

503CHSS

503DHSSTF

503EHSSTF

## ACCESSORIES

- Special Foots F5070A
- Rail G30-04
- Trailers C30-04 • C30-0401
- C30-0402
- Stopper S30-04
- Remote Handles 70SMA

- Blocking Pins F5057
- Butterfly Keys F5059
- Gear Grease T107900
- Metal Gloves GMT-REV

# DS503MT

ELECTRIC HAND SHEARS

TEXTILE

TECHNICAL  
TEXTILE

COMPOSITE

## SPECIFICATIONS

- Blade diameter:** 50 mm (1.96"), with welded hard metal counterblade
- Blade descr.:** 50SEXT, 7-edges, EXTRA steel
- Blade speed:** 1500 r.p.m.
- Cutting ability:** 9 mm (0.35")
- Power:** singlephase – 55 W
- Max absorption:** 1 A, with protection fuse
- Net weight (with power supply cord):** 950 g
- Total weight (with packaging):** 1570 g
- Electric cable length:** 1.5 mt (extensible)
- Minimum brightness for working operations:** 200 LUX
- Vibrations at start up:** < 2.5 m/sec<sup>2</sup>
- Temperature range:** 0 – 55 C
- Umidity range:** 10 – 95% without condensate



## SAFETY

- Safety start/stop device system
- Fixed transparent fore blade protection
- 1 A cut-off fuse
- Double electric insulation



## DESCRIPTION

DS503MT is the new electrical hand-held cutting machine designed for trimming the edges. The new slim shaped foot is welded with a wide counterblade to reduce the overall dimension of the shear. With DS503MT is therefore possible to trim straight or curved sections of material with high precision. DS503MT is well used for trimming textile and leather in furnishing field (chairs, sofa and armchairs) while especially used to cut away the extra-waste material on moulds for plastic and glass fiber. It weighs only 950 grams and its ergonomic design combined with a 55Watt balanced and silenced motor make this model a unique cutting tool very easy to be used. The maximum cutting thickness is 8mm and the new installed sharpening stone allows the sharpening of the knife edge to be done in less than 10 seconds without removing the knife. The new circuit board includes a glass fuse which can be easily replaced without disassembling the shear.



## ACCESSORIES

- Blocking Pins** F5057
- Butterfly Keys** F5059
- Gear Grease** T107900
- Metal Gloves** GMT-REV

## BLADES Ø 50 MM



50SEXT

50SHSS

50SEXTG

50SGHSS

50CHSS

50CK

50SHSSTF

TEXTILE

TECHNICAL  
TEXTILE

COMPOSITE

# OPTIMA 702

ELECTRIC HAND SHEARS



## SPECIFICATIONS

- Blade diameter:** 70 mm (2.75"), with hard metal counterblade
- Blade descr.:** 70SHSS, 4-edges, HSS steel
- Blade Speed:** 750 r.p.m.
- Cutting ability:** 18 mm (0.7")
- Power:** monofase – 150 W
- Max absorption:** 1.25 A, with protection fuse
- Net weight (with power supply cord):** 1150 g
- Total weight (with packaging):** 2100 g
- Electric cable length:** 1.5 mt (estensibile)
- Minimum brightness for working operations:** 200 LUX
- Vibrations at start up:** < 2.5 m/sec<sup>2</sup>
- Temperature range:** 0 – 55 C
- Umidity range:** 10 – 95% without condensate



## SAFETY

- Safety start/stop device system
- Height-adjustable transparent fore blade protection
- Fixed transparent back blade protection
- 1.25 A cut-off fuse
- Double electric insulation

## DESCRIPTION

This latest version in the OPTIMA series results a truly revolutionary hand-held cutting machine. Already over 1000 units sold of previous version the new 2014 model grant a highest level in technology ever reached before for a cutting tool of such a small size. Within small size and weight this model OPTIMA 702 reaches a power of 150 Watt which combined with a bronze and high resistance steel gear coupling allows an impressive cutting torque. OPTIMA 702 is able to cut any kind of soft material up to 18mm thickness. It is for this reason which is widely applied in textile, technical fabrics and composite material. The high torque and the slow speed of the knife allow to cut also rubber or plastic base material in the field of carpets and flooring. The steel foot being strong and of small dimension allows a very precise and easy cut of straight or curve sections. The push button sharpening stone allows the sharpening of the knife edge to be done in less than 10 seconds without removing the knife. The new circuit board includes a glass fuse which can be easily replaced without disassembling the shear and the new rare fixed protection is in transparent plastic to give better visibility during cutting operation. OPTIMA 702 is the cutting tool most revolutionary and powerful on the market able to satisfy any kind of cutting professional demand.



## BLADES Ø 70 MM



## ACCESSORIES

- Grinders** SW1086DIA
- Rail** G30-04
- Trailers** C30-04, C30-0401
- Stopper** S30-04
- Remote Handles** 70SMA
- Blocking Pins** F5057
- Butterfly Keys** F5059
- Gear Grease** T107900
- Metal Gloves** GMT-REV







# **THE SOLUTION FOR NON STOP WORKING**

**Pneumatic hand shears**





TEXTILE

TECHNICAL  
TEXTILE

COMPOSITE

# FP503

PNEUMATIC HAND SHEARS



## SPECIFICATIONS

**Blade diameter:** 50 mm (1.96"), with hard metal counterblade

**Blade descr.:** 503EEHSS, 6-edges, HSS steel

**Blade speed:** 1900 r.p.m.\*

**Cutting ability:** 9 mm (0,35")

**Power:** 350 W (at nominal air supply conditions)\*

**Working pressure:** 6 bar\* (±1 bar) with lubricated air

**Air consumption:** 9 l/sec\*

**Net weight:** 800 g

**Total weight (with packaging):** 1630 g

**Sound pressure:** 72 dB (EN ISO 15744)\*

**Vibrations at start up:** 1,36 m/sec<sup>2</sup> (ISO 8662)\*

**Minimum brightness for working operations:** LUX 200

**Temperature range:** 0 – 55 C

**Umidity range:** 10 – 95% without condensate

\* The reported data are collected at a pressure of 6 bar (ISO 2787: 1984), recommended operating pressure

\* Rasor recommend to use only dry air lubricated with special Rasor VG 5 pneumatic oil



## SAFETY

Safety start/stop device system

Fixed transparent fore blade protection

1 A cut-off fuse

Double electric insulation

## DESCRIPTION

The newest model in FP series, FP503 is the lighter and most powerful pneumatic hand-held cutting tool Rasor have ever produced in more than 70 years of work. The air motor is wholly made by Rasor. Thanks to latest generation pneumatic and mechanical components, the turbine reaches an extraordinary power of 350Watt in 22,000 RPM and a very high torque. The motor diameter is only 40mm that is the smallest within its category. The rotor blades are designed and produced in VANESTAR material so to reduce to minimum the weight and the friction. The cutting part has also been wholly reassessed: a reinforced structure and bronze/steel gear coupling create a high torque which allows the use of this pneumatic cutting tool not only in textile field but also in technical fabrics or leather fields. The max cutting thickness is now 9mm and the new push button sharpening stone allows the sharpening of the knife edge to be done in less than 10 seconds without removing the knife. The new stong and slim shaped foot allows to trim curved sections very easily. The new model FP503 is truly a novel concentration of power and lightness (it weights only 800 grams) in the field of professional cutting tool.



## BLADES Ø 50 MM



503EEXT

503EHSS

503DHSS

503CHSS

503DHSSTF

503EHSSTF

## ACCESSORIES

**Special Feet** F5070A

**Rail** G30-04

**Trailers** C30-04, C30-0401

C30-0402

**Stopper** S30-04

**Fast Connectors** P170, P171

**Regulators** P168

**Tube** P173

**Silencers** P029

**Lubricants** T107902

T107903

**Blocking Pins** F5057

**Butterfly Keys** F5059

**Gear Grease** T107900

**Metal Gloves** GMT-REV



# FP503MT

PNEUMATIC HAND SHEARS

TEXTILE

TECHNICAL  
TEXTILE

COMPOSITE



## SPECIFICATIONS

**Blade diameter:** 50 mm (1.96"), with welded hard metal counterblade

**Blade descr.:** 50SHSS, 7-edges, HSS steel

**Blade speed:** 1900 r.p.m.\*

**Cutting ability:** 9 mm (0,35")

**Power:** 350 W (at nominal air supply conditions)\*

**Working pressure:** 6 bar\* ( $\pm 1$  bar) with lubricated air

Air consumption: 9 l/sec\*

**Net weight:** 780 g

**Total weight (with packaging):** 1600 g

**Sound pressure:** 72 dB (EN ISO 15744)\*

**Vibrations at start up:** 1,36 m/sec<sup>2</sup> (ISO 8662)\*

**Minimum brightness for working operations:** LUX 200

**Temperature range:** 0 – 55 C

**Umidity range:** 10 – 95% without condensate

\* The reported data are collected at a pressure of 6 bar (ISO 2787: 1984), recommended operating pressure

\* Rasor recommend to use only dry air lubricated with special Rasor VG 5 pneumatic oil



## DESCRIPTION

The new hand held cutting tool model FP503MT has been designed for the trimming edges cutting. The new foot has a slim shape with a welded carbide counterblade, that is to reduce the overall dimensions. This cutting tool is thus applied to trim with very high precision material having straight or curved edges. It is mainly used for trimming textile and leather within the furniture field and it is especially suitable for trimming away the over material in the molds for carbon fiber and glass fiber. The air compressed motor is wholly made by Rasor. Thanks to the latest generation mechanical and pneumatic components, the excellent turbine reaches a power of 350W at 22,000 RPM and a high torque. The motor diameter is now of only 40mm that is the smallest within its category. The rotor blades are made of VANESTAR material which reduce to the minimum the weight and the friction. The maximum cutting thickness is of 9mm and the sharpening stone allows the sharpening of the knife edge to be done in less than 10 seconds without removing the knife. It is truly a novel concentration of power and lightness (it weighs only 780 grams) in the field of professional cutting tools.

## SAFETY

Double safety start-up system device

Fixed transparent fore blade protection



## ACCESSORIES

**Fast Connectors** P170, P171

**Regulators** P168

**Tube** P173

**Silencers** P029

**Lubricants** T107902

T107903

**Blocking Pins** F5057

**Butterfly Keys** F5059

**Gear Grease** T107900

**Metal Gloves** GMT-REV

## BLADES Ø 50 MM



50SEXT

50SHSS

50SEXTG

50SGHSS

50CHSS

50CK

50SHSSTF



TEXTILE

TECHNICAL  
TEXTILE

COMPOSITE

# FP70

PNEUMATIC HAND SHEARS



## SPECIFICATIONS

- Blade diameter:** 70 mm (2.75"), with hard metal counterblade
- Blade descr.:** 70EHSS, 6-edges, HSS steel
- Blade speed:** 900 r.p.m.\*
- Cutting ability:** 18 mm (0.7")
- Power:** 380 W (at nominal air supply conditions)\*
- Working pressure:** 6 bar\* ( $\pm 1$  bar) with lubricated air
- Air consumption:** 9 l/sec\*
- Net weight:** 920 g
- Total weight (with packaging):** 1750 g
- Sound pressure:** 72 dB (EN ISO 15744)\*
- Vibrations at start up:** 1,36 m/sec<sup>2</sup> (ISO 8662)\*
- Minimum brightness for working operations:** LUX 200
- Temperature range:** 0 – 55 C
- Umidity range:** 10 – 95% without condensate

\* The reported data are collected at a pressure of 6 bar (ISO 2787: 1984), recommended operating pressure

\* Rasor recommend to use only dry air lubricated with special Rasor VG 5 pneumatic oil



## SAFETY

- Height-adjustable transparent fore blade protection
- Fixed transparent back blade protection
- Thermic protection inside the battery

## DESCRIPTION

The model FP70 is the best compromise between weight and powerfull in the field of professional pneumatic hand-held cutting tools. The air motor is wholly made by Rasor. Thanks to latest generation pneumatic and mechanical components, the turbine reaches an extraordinary power of 380Watt in 22,000 RPM and a very high torque. The motor diameter is now only 40mm that is the smallest within its category. The rotor blades are designed and produced in VANESTAR material so to reduce to minimum the weight and the friction. The model FP70 weights only 920 grams and it is able to cut any kind of material at the "flexible stage" up to maximum cutting thickness of 18mm. This is the reason why this model is normally applied in textile, technical fabric and composite material field. The high torque and the low speed of the knife allow to cut even rubber material with plastic base within the carpet and flooring application. The foot is steel made, strong and of small dimension so to allow cutting straight or curved sections easily and precisely. The push button sharpening stone allows the sharpening of the knife edge to be done in less than 10 seconds without removing the knife. The new fixed rear protection is now transparent plastic made to have more visibility during the cutting operations. Model FP70 is the best solution able to satisfy any need in the field of professional cutting tool.



## BLADES Ø 70 MM



## ACCESSORIES

- Grinders** SW1086DIA
- Rail** G30-04
- Trailers** C30-04, C30-0401
- C30-0402
- Stopper** S30-04
- Fast Connectors** P170, P171
- Regulators** P168

- Tube** P173
- Silencers** P029
- Lubricants** T107902
- T107903
- Blocking Pins** F5057
- Butterfly Keys** F5059
- Gear Grease** T107900
- Metal Gloves** GMT-REV

70SHSS 70EHSS 70CHSS 70DHSS 70EHSSTF 70SHSSTF 70EMD

# FP861

PNEUMATIC HAND SHEARS

TEXTILE

TECHNICAL  
TEXTILE

COMPOSITE

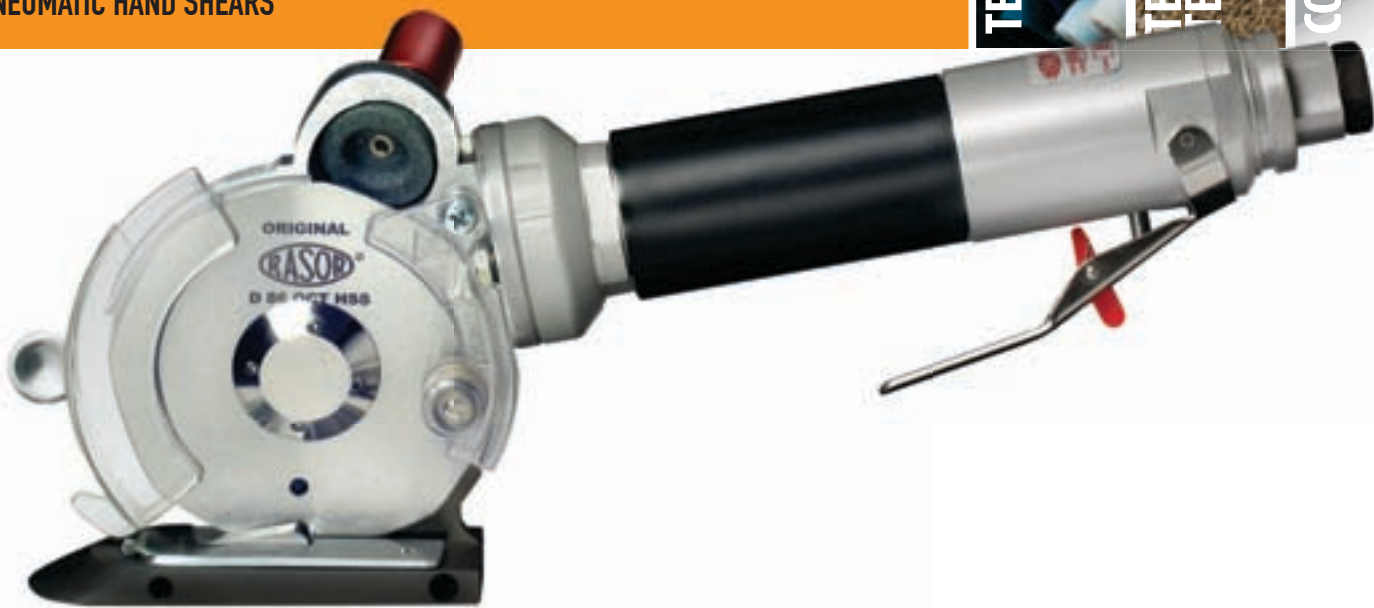

## SPECIFICATIONS

- Blade diameter:** 86 mm (3.4"), with hard metal counterblade
- Blade descr.:** 86THSS, 8-edges, HSS steel
- Blade speed:** 900 r.p.m.\*
- Cutting ability:** 25 mm (1")
- Power:** 400 W (at nominal air supply conditions)\*
- Working pressure:** 6 bar\* (±1 bar) with lubricated air
- Air consumption:** 9 l/sec\*
- Net weight:** 1100 g
- Total weight (with packaging):** 1995 g
- Sound pressure:** 72 dB (EN ISO 15744)\*
- Vibrations at start up:** 1,36 m/sec<sup>2</sup> (ISO 8662)\*
- Minimum brightness for working operations:** LUX 200
- Temperature range:** 0 – 55 C
- Umidity range:** 10 – 95% without condensate

\* The reported data are collected at a pressure of 6 bar (ISO 2787: 1984), recommended operating pressure  
 \* Rasor recommend to use only dry air lubricated with special Rasor VG 5 pneumatic oil



## DESCRIPTION

New model FP861 is the most powerful pneumatic hand held cutting machine ever produced by Rasor. Air compressed motor is wholly made by Rasor. thanks to the latest generation mechanical and pneumatic components, this excellent turbine reaches a power of 400W with 20.000 RPM and a very high torque. The diameter of motor is now of 40mm only, the smallest within its category. The rotor blade are made of VANESTAR material which reduce to the minimum the weight and the friction. The model FP861 with a knife of 86mm diameter and 8-edges is able to cut any kind of material at the "flexible stage" up to maximum cutting thickness of 25mm. This is the reason why this model is normally used in textile, technical fabric and composite material field. Due to high powerfull it is able to cut several layers of fiber glass and carbon fiber. The high torque and the low speed of the knife allow to cut even rubber material with plastic base within the carpet and flooring application. The foot is aluminium made, light and small dimension so to allow cutting straight or curved sections easily and precisely. The push button sharpening stone allows the sharpening of the knife edge to be done in less than 10 seconds without removing the knife. The new fixed rear protection is now transparent plastic made to have more visibility during the cutting operations.

## SAFETY

- Double safety start-up system device
- Height-adjustable transparent fore blade protection
- Fixed transparent back blade protection



## ACCESSORIES

- Grinders** SW1086DIA
- Counterblades** SW1081DIA
- Rail** G30-04
- Trailers** C30-04, C30-0401
- C30-0402
- Stopper** S30-04
- Fast Connectors** P170, P171

- Regulators** P168
- Tube** P173
- Silencers** P029
- Lubricants** T107902, T107903
- Blocking Pins** T107600
- Butterfly Keys** T107500
- Gear Grease** T107900
- Metal Gloves** GMT-REV

## BLADES Ø 86 MM



86THSS

86PHSS

86PHSSTF

86THSSTF

86THSSTN

86TMD



TEXTILE

TECHNICAL  
TEXTILE

COMPOSITE

# FP861MT

PNEUMATIC HAND SHEARS



## SPECIFICATIONS

- Blade diameter:** 86 mm (3.4"), with hard metal counterblade
- Blade descr.:** 86THSS, 8-edges, HSS steel
- Blade speed:** 900 r.p.m.\*
- Cutting ability:** 25 mm (1")
- Power:** 400 W (at nominal air supply conditions)\*
- Working pressure:** 6 bar\* (±1 bar) with lubricated air
- Air consumption:** 9 l/sec\*
- Net weight:** 1100 g
- Total weight (with packaging):** 1995 g
- Sound pressure:** 72 dB (EN ISO 15744)\*
- Vibrations at start up:** 1,36 m/sec<sup>2</sup> (ISO 8662)\*
- Minimum brightness for working operations:** LUX 200
- Temperature range:** 0 – 55 C
- Umidity range:** 10 – 95% without condensate

## DESCRIPTION

Even though this model FP861MT has only been recently presented during JEC Composite Show 2013 in Paris, this hand held cutting tool is already become the most appreciated cutting tool all over the world. Model FP861 cuts easily glass fiber, carbon fiber and kevlar up to a cutting thickness of 25mm. It weights only 1100 grams and the particular geometry between the knife and carbide counterblade combined with an innovative shape of the foot allow the cut of composite material with an extraordinary speed and precision. Especially the the shape of the front peak allows the application of this cutting tool for edge trimming i.e. mould trimming. Furthermore, these particular building geometry avoid totally the trouble on winding for composite material such as the winding of the fiber behind the knife. Air compressed motor is wholly made by Rasor. thanks to the latest generation mechanical and pneumatic components, this excellent turbine reaches a power of 400W with 20,000 RPM and a very high torwue. The diameter of motor is now of 40mm only, the smallest within its cathegory. The rotor blade are made of VANESTAR material which reduce to the minimun the weight and the friction. The push button sharpening stone allows the sharpening of the knife edge to be done in less than 10 secondswithout removing the knife. The new fixed rear protection is now transparent plastic made to have more visibility during the cutting operations. Nowadays most of the producers/end users of composite material use normally model FP861MT for their cutting operations. Automotive, Shipbuilding and Aerospace Industry are the fields where this model FP861MT is mainly applied.

\* The reported data are collected at a pressure of 6 bar (ISO 2787: 1984), recommended operating pressure  
 \* Rasor reccomend to use only dry air lubricated with special Rasor VG 5 pneumatic oil

## SAFETY

- Double safety start-up system device
- Heigh-adjustable trasparent fore blade protection
- Fixed trasparent back blade protection



## BLADES Ø 86 MM



86THSS

86PHSS

86PHSSTF

86THSSTF

86THSSTN

86TMD

## ACCESSORIES

- Grinders SW1086DIA
- Fast Connectors P170, P171
- Regulators P168
- Tube P173
- Silencers P029
- Lubricants T107902, T107903

- Blocking Pins T107600
- Butterfly Keys T107500
- Gear Grease T107900
- Metal Gloves GMT-REV

# FP861RC

## PNEUMATIC HAND SHEARS

TEXTILE

TECHNICAL  
TEXTILE

COMPOSITE



### SPECIFICATIONS

- Blade diameter:** 86 mm (3.4")
- Blade descr.:** 86THSSSTF, 8-edges, HSS steel Teflon® coated
- Blade speed:** 900 r.p.m.\*
- Cutting ability:** 3-10-20 mm (0.1-0.4-0.8"), with selector knob
- Power:** 400 W (at nominal air supply conditions)\*
- Working pressure:** 6 bar\* (±1 bar) with lubricated air
- Air consumption:** 9 l/sec\*
- Net weight:** 1600 g
- Total weight (with packaging):** 3300 g
- Sound pressure:** 72 dB (EN ISO 15744)\*
- Vibrations at start up:** 1,36 m/sec<sup>2</sup> (ISO 8662)\*
- Minimum brightness for working operations:** LUX 200
- Temperature range:** 0 – 55 C
- Umidity range:** 10 – 95% without condensate

\* The reported data are collected at a pressure of 6 bar (ISO 2787: 1984), recommended operating pressure  
 \* Rasor recommend to use only dry air lubricated with special Rasor VG 5 pneumatic oil

### SAFETY

- Double safety start-up system device
- Height-adjustable transparent fore blade protection
- Fixed transparent back blade protection
- Blade 100% covered on position "0"



### DESCRIPTION

The pneumatic hand-held model FP861RC is definitely the most innovative and clever cutting tool. It allows the cut of material from the top (etching operation) by a 5-edges knife that comes out from the structure of the machine through the only pressure of the user. The model FP861RC is suitable mainly for cutting material in rolls shape like paper, fabric or recycle material. Beside, it can be used to cut flooring to be removed or disposed. The cutting operation of FP861RC is not through removing material but etching the material. A selector allows to adjust the outcoming knife in three positions: cutting thickness of 3mm, 10mm or 20mm. This model FP861RC is suitable to shear the paper rolls whenever it is necessary to cut in depth (20mm) and smaller cut (10mm or 3mm) to save the inside core (i.e. the carton roll). Model FP861RC replaces the use of standard blades and knives while increase the speed and quality of cut and the safety of the operators. Air compressed motor is wholly made by Rasor. thanks to the latest generation mechanical and pneumatic components, this excellent turbine reaches a power of 400W with 20,000 RPM and a very high torque. The diameter of motor is now of 40mm only, the smallest within its category. The rotor blade are made of VANESTAR material which reduce to the minimum the weight and the friction. The push button sharpening stone allows the sharpening of the knife edge to be done in less than 10 seconds without removing the knife. The installed knife is 86mm diameter and teflon coated in order to go smoothly through the material and to reduce the friction between the knife and cutting material.



### ACCESSORIES

- Grinders** SW1086DIA
- Fast Connectors** P170, P171
- Regulators** P168
- Tube** P173
- Silencers** P029
- Lubricants** T107902, T107903

- Blocking Pins** T107600
- Butterfly Keys** T107500
- Gear Grease** T107900
- Metal Gloves** GMT-REV

### BLADES Ø 86 MM



86THSS

86PHSS

86PHSSTF

86THSSTF

86THSSTN

86TMD





**RELIABLE &  
PROFESSIONAL**

**Electric bench cutters**





MISUBA

5  
6  
7  
8  
9  
10  
11  
12  
13

125  
126  
127  
128  
129  
130  
131  
132

TEXTILE

TECHNICAL  
TEXTILE

POSITIVE

# D86

ELECTRIC BENCH CUTTERS



## SPECIFICATIONS

- Blade diameter:** 86 mm (3.4")
- Blade descr.:** 86CEXT, circular, EXTRA steel
- Blade speed:** 1000 r.p.m.
- Cutting ability:** 25 mm (1")
- Power:** singlephase – 90 W
- Max absorption:** 2 A, with protection fuse
- Net weight (with power supply cord):** 2900 g
- Total weight (with packaging):** 4600 g
- Electric cable length:** 1.5 mt (with no plug)
- Minimum brightness for working operations:** 200 LUX
- Vibrations at start up:** < 2.5 m/sec<sup>2</sup>
- Temperature range:** 0 – 55 C
- Umidity range:** 10 – 95% without condensate



## SAFETY

- Double safety start-up system device
- Main power switch with Led indicator
- High-adjustable transparent fore blade protection
- Fixed transparent back blade protection
- 2 A cut-off fuse
- Double electric insulation

## DESCRIPTION

D86 is the smallest model of bench cutting machine operating with a round knife. Model D86 is a powerful and easy-handling cutting machine which weighs less than 3 kilos. It finds large application in textile field and especially suitable to cut natural fiber as cotton, wool or silk. The semiautomatic stone sharpening system which can be operated by a proper lever allows the sharpening of the knife edge to be done in less than 10 seconds without removing the knife. Its aluminium base with rolls is Teflon® coated to be friction proof and to grant an easy feed with no efforts. The few maintenance and low operation cost make this model the best cutting machine for any application in textile field.



## BLADES Ø 86 MM



86CEXT



86CHSS

## ACCESSORIES

- Rail G30-03
- Trailers C30-0301, C30-0302
- Stopper S30-03
- Butterfly Keys T107500
- Blocking Pins T107600

- Gear Grease T107900
- Metal Gloves GMT-REV



# D100

## ELECTRIC BENCH CUTTERS

TEXTILE

TECHNICAL  
TEXTILE

COMPOSITE

### SPECIFICATIONS

**Blade diameter:** 100 mm (4")

**Blade descr.:** 10CEXTG, circular, EXTRA steel

**Blade speed:** 1000 r.p.m.

**Cutting ability:** 35 mm (1.4")

**Power:** singlephase – 90 W

**Max absorption:** 2 A, with protection fuse

**Net weight (with power supply cord):** 2950 g

**Total weight (with packaging):** 4650 g

**Electric cable length:** 1.5 mt (with no plug)

**Minimum brightness for working operations:** 200 LUX

**Vibrations at start up:** < 2.5 m/sec<sup>2</sup>

**Temperature range:** 0 – 55 C

**Umidity range:** 10 – 95% without condensate

### SAFETY

Double safety start-up system device

Main power switch with Led indicator

Height-adjustable transparent fore blade protection

Fixed transparent back blade protection

2 A cut-off fuse

Double electric insulation

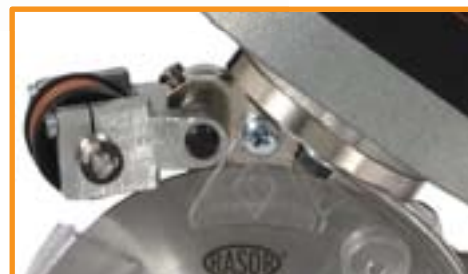

### DESCRIPTION

For over 40 years within the market, the model D100 is the most efficient and popular bench cutting machine in textile application. It weighs less than 3 kilos and reached the highest level in technology and safety resulting a powerful and easy-handling cutting machine. It finds Wide application in textile field. It is especially suitable to cut natural fiber as cotton, wool or silk. The semiautomatic sharpening stone system to be operated by a proper lever allows the sharpening of the knife edge to be done in less than 10 seconds without removing the knife. The aluminium base with rolls is Teflon® coated to be friction proof and to grant an easy feed with no efforts.

The low maintenance and low operation cost make surely this model the best cutting machine for any application in textile field.



### ACCESSORIES

**Rail** G30-03

**Trailers** C30-0301, C30-0302

**Stopper** S30-03

**Butterfly Keys** T107500

**Blocking Pins** T107600

**Gear Grease** T107900

**Metal Gloves** GMT-REV

### BLADES Ø 100 MM



10CEXTG



10CGHSS



10CFR



TEXTILE

TECHNICAL  
TEXTILE

COMPOSITE

# D86P

ELECTRIC BENCH CUTTERS



## SPECIFICATIONS

**Blade diameter:** 86 mm (3.4"), with hard metal counterblade

**Blade descr.:** 86PHSS, 5-edges, HSS steel

**Blade speed:** 850 r.p.m.

**Cutting ability:** 25 mm (1")

**Power:** singlephase – 90 W

**Max absorption:** 2 A, with protection fuse

**Net weight (with power supply cord):** 2900 g

**Total weight (with packaging):** 4600 g

**Electric cable length:** 1.5 mt (with no plug)

**Minimum brightness for working operations:** 200 LUX

**Vibrations at start up:** < 2.5 m/sec<sup>2</sup>

**Temperature range:** 0 – 55 C

**Umidity range:** 10 – 95% without condensate



## SAFETY

Double safety start-up system device

Main power switch with Led indicator

Height-adjustable transparent fore blade protection

Fixed transparent back blade protection

2 A cut-off fuse

Double electric insulation

## DESCRIPTION

D86P is the smallest model in Razor range of bench cutting machine with a wide counterblade. It is a powerful and easy-handling cutting machine which weighs less than 3 kilos. The 5-edge knife assures a sharp and precise cut without rag grinding. The diameter of the knife being only 86mm allows an ease curve trimming and thin sections. The semiautomatic stone sharpening system allows the sharpening of the knife edge to be done in only 10 seconds without removing the knife. The aluminium base with rolls is Teflon® coated to be friction proof and to grant an easy feed with no efforts. D86P is widely applied in textile, technical fabrics and in the leather and carpets industries. The few maintenance and low operation cost make D86P to be the best cutting solution for any of your application.



## BLADES Ø 86 MM



86THSS

86PHSS

86PHSSTF

86THSSTF

86THSSTN

86TMD

## ACCESSORIES

Counterblades SW1081DIA

Rail G30-03

Trailers C30-0301, C30-0302

Stopper S30-03

Butterfly Keys T107500

Blocking Pins T107600

Gear Grease T107900

Metal Gloves GMT-REV

# SW100

ELECTRIC BENCH CUTTERS

TEXTILE

TECHNICAL  
TEXTILE

COMPOSITE



## SPECIFICATIONS

- Blade diameter:** 100 mm (4"), with hard metal counterblade
- Blade descr.:** 10EHSS, 6-edges, HSS steel
- Blade speed:** 850 r.p.m.
- Cutting ability:** 35 mm (1.4")
- Power:** singlephase – 90 W
- Max absorption:** 2 A, with protection fuse
- Net weight (with power supply cord):** 2950 g
- Total weight (with packaging):** 4650 g
- Electric cable length:** 1.5 mt (with no plug)
- Minimum brightness for working operations:** 200 LUX
- Vibrations at start up:** < 2.5 m/sec<sup>2</sup>
- Temperature range:** 0 – 55 C
- Umidity range:** 10 – 95% without condensate

## SAFETY

- Double safety start-up system device
- Main power switch with Led indicator
- Height-adjustable transparent fore blade protection
- Fixed transparent back blade protection
- 2 A cut-off fuse
- Double electric insulation



## DESCRIPTION

For over 30 years within the market, SW100 is the most efficient and popular bench cutting machine in textile and technical fabrics fields. It reached the highest level of technology and safety and can grant power and easy handling due to its weigh of only 3 kilos. The combination between blade and counterblade make the cut to be sharp and precise without any rag grinding. The 90Watt balanced and silenced motor combined with high resistance bronze/steel gear couplings create a long lasting stability. The 6-edge 100mm diameter knife allows to cut any kind of fabric up to 35mm thickness. The aluminium cutter base with rolls is Teflon® coated to be friction proof and grant an easy feed of the fabric with no efforts. The push button sharpening stone allow the sharpening of the knife edge to be done in less than 10 seconds without removing the knife. The low maintenance and low operation cost make surely SW100 to be the best cutting machine suitable for any application in textile and technical fabrics fields.



## ACCESSORIES

- Grinders** SW1086DIA
- Counterblades** SW1081DIA
- Rail** G30-03
- Trailers** C30-0301, C30-0302
- Stopper** S30-03
- Butterfly Keys** T107500
- Blocking Pins** T107600
- Gear Grease** T107900
- Metal Gloves** GMT-REV

## BLADES Ø 100 MM





TEXTILE

TECHNICAL  
TEXTILE

COMPOSITE

# SW12

ELECTRIC BENCH CUTTERS



## DESCRIPTION

SW12 is the biggest Razor bench cutting machine. For over 25 years within the market, the model SW12 reached the highest level in technology and safety and still can collect a big success in the high thickness cutting application. Its 120mm diameter knife allows the cut of fabrics upto 50mm thickness. The powerfull 180Watt motor combined with a strong bronze/steel coupling gears create high torque plus a high blade speed of 850RPM. SW12 is widely applied in textile or technical fabrics fields and it is especially suitable to cut high thickness material like mattress, foams and natural fibers in many layers. The new push button sharpening stone allows the sharpening of the knife edge to be done in less than 10 seconds without removing the knife. The aluminium cutting base with rolls is Teflon® coated to allow the easy feed of the machine and the reduction of the friction between the platform and the material. Model SW12 is definitely the best professional bench cutting machine for high thickness.



## SPECIFICATIONS

- Blade diameter:** 120 mm (4.7"), with hard metal counter-blade
- Blade descr.:** 12SHSS, 8-edges, HSS steel
- Blade speed:** 850 r.p.m.
- Cutting ability:** 50 mm (2")
- Power:** singlephase – 180 W
- Max absorption:** 2.5 A, with protection fuse
- Net weight (with power supply cord):** 4500 g
- Total weight (with packaging):** 6200 g
- Electric cable length:** 1.5 mt (with no plug)
- Minimum brightness for working operations:** 200 LUX
- Vibrations at start up:** < 2.5 m/sec<sup>2</sup>
- Temperature range:** 0 – 55 C
- Umidity range:** 10 – 95% without condensate

## SAFETY

- Double safety start-up system device
- Main power switch with Led indicator
- Height-adjustable transparent fore blade protection
- Fixed transparent back blade protection
- 2.5 A cut-off fuse
- Double electric insulation

## BLADES Ø 120 MM



12SHSS    12CSW    12DHSS    12SHSSTF    12SHSSTN    12DHSSTN    12SMD

## ACCESSORIES

- Grinders** SW1286DIA
- Counterblades** SW1081DIA
- Rail** G30-03
- Trailers** C30-0301, C30-0302
- Stopper** S30-03
- Butterfly Keys** T107500
- Blocking Pins** T107600
- Gear Grease** T107900
- Metal Gloves** GMT-REV

# SW12M

## ELECTRIC BENCH CUTTERS

TECHNICAL  
TEXTILE

COMPOSITE

### SPECIFICATIONS

- Blade diameter:** 120 mm (4.7"), with hard metal counterblade
- Blade descr.:** 12SHSS, 8-edges, HSS steel
- Blade speed:** 550 r.p.m.
- Cutting ability:** 50 mm (2")
- Power:** singlephase – 350 W
- Max absorption:** 2.5 A, with protection fuse
- Net weight (with power supply cord):** 4500 g
- Total weight (with packaging):** 6200 g
- Electric cable length:** 1.5 mt (with no plug)
- Minimum brightness for working operations:** 200 LUX
- Vibrations at start up:** < 2.5 m/sec<sup>2</sup>
- Temperature range:** 0 – 55 C
- Umidity range:** 10 – 95% without condensate



### SAFETY

- Double safety start-up system device
- Main power switch with Led indicator
- Height-adjustable transparent fore blade protection
- Fixed transparent back blade protection
- 2.5 A cut-off fuse
- Double electric insulation



### DESCRIPTION

SW12M is Rasor new generation bench cutting machine. Launched on the market only a couple of months ago SW12M gives its excellency to the new geometry of the motor housing of Monster series. The difference between SW12M and the other Rasor bench cutting machine is given by its motor housing held by a central foot fitted behind the blade in central position. This system spreads the shearing stress and the necessary stress to move the machine through the fabrics on both sides of the cutter and cut is so done perfectly straight and smooth. The knife is half-free on both sides to avoid winding problems even with tough fibers. SW12M is especially suitable to cut composite materials like glass fiber, carbon fiber, kevlar or any soft material up to 50mm thickness. The impressive 350Watt motor combined with a bronze/steel coupling gear create a very high torque which combined with the slow RPM of the knife allow to cut even rubber materials and plastic based material in the field of carpets and industrial flooring. The push button sharpening stone allows the sharpening of the knife edge to be done in less than 10 seconds without removing the knife. SW12M...just over the limits.



### ACCESSORIES

- Grinders** SW1286DIA
- Counterblades** SW1081DIA
- Rail** G30-03
- Trailers** C30-0301, C30-0302
- Stopper** S30-03
- Butterfly Keys** T107500

- Blocking Pins** T107600
- Gear Grease** T107900
- Metal Gloves** GMT-REV

### BLADES Ø 120 MM





# **POWER & PRODUCTION EFFICIENCY**

**Pneumatic cutting units**







TEXTILE

TECHNICAL  
TEXTILE

COMPOSITE

# FP861V

PNEUMATIC CUTTING UNITS

## SPECIFICATIONS

- Blade diameter:** 86 mm (3.4"), with hard metal counterblade
- Blade descr.:** 86THSS, 8-edges, HSS steel
- Blade speed:** 900 r.p.m.\*
- Cutting ability:** 25 mm (1")
- Power:** 400 W (at nominal air supply conditions)\*
- Working pressure:** 6 bar\* (±1 bar) with lubricated air
- Air consumption:** 9 l/sec\*
- Net weight:** 1300 g
- Total weight (with packaging):** 3000 g
- Sound pressure:** 72 dB (EN ISO 15744)\*
- Vibrations at start up:** 1,36 m/sec<sup>2</sup> (ISO 8662)\*
- Minimum brightness for working operations:** LUX 200
- Temperature range:** 0 – 55 C
- Umidity range:** 10 – 95% without condensate

\* The reported data are collected at a pressure of 6 bar (ISO 2787: 1984), recommended operating pressure  
 \* Razor recommend to use only dry air lubricated with special Razor VG 5 pneumatic oil

## SAFETY

- High-adjustable transparent fore blade protection
- Fixed transparent back blade protection

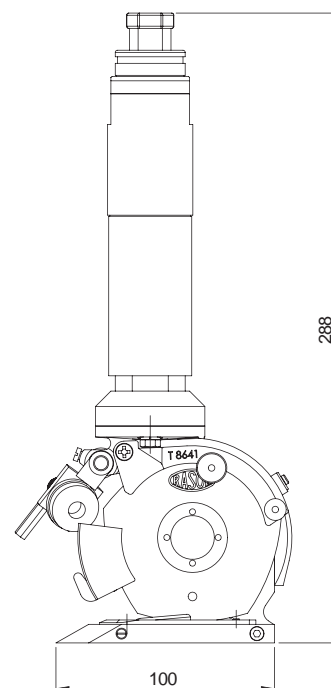

## DESCRIPTION

Model FP861V is a pneumatic cutting unit to cut textile and technical fabrics. The air compressed motor is wholly made by Rasor. Thanks to the latest generation mechanical and pneumatic components, the excellent turbine reaches a power of 400W at 20,000 RPM and a high torque. The motor diameter is now of 40mm only that is the smallest within its category. The rotor blades are made of VANESTAR® material which reduce to the minimum the weight and the friction. The installed knife of 86mm diameter 5-edges allow the cutting of any kind of material at the "flexible stage" up to a cutting thickness of 25mm. The high torque and the slow speed of the knife allow the cutting of rubber material with plastic base in the carpet and light flooring application. Especially suitable for transversal cutting the model FP861V is also suitable to be installed in small spaces thanks to the vertical position of the motor. This model is arranged with an anchor flange easy to be fitted on fixed or automatic stirrup. The base is Teflon® coated and allows the easy movement of the cutting tool reducing the friction between the base and the cutting material. It can be installed on sliding rails within a small space. The semi-automatic push button sharpening stone allows the sharpening of the knife edge to be done in less than 10 seconds without removing the knife. The small maintenance and small handling costs make the model FP861V the best solution for a powerful and reliable cutting within any O.E.M. application.



## BLADES Ø 86 MM



## ACCESSORIES

- Grinders** SW1086DIA
- Counterblades** SW1081DIA
- Fast Connectors** P170, P171
- Regulators** P168
- Tube** P173
- Silencers** P029
- Lubricants** T107902, T107903
- Butterfly Keys** T107500
- Blocking Pins** T107600
- Gear Grease** T107900
- Metal Gloves** GMT-REV



# FP861A1

## PNEUMATIC CUTTING UNITS

TEXTILE

TECHNICAL  
TEXTILE

COMPOSITE

### SPECIFICATIONS

**Blade diameter:** 86 mm (3.4"), with hard metal counterblade

**Blade descr.:** 86PHSS, 5-edges, HSS steel

**Blade speed:** 900 r.p.m.\*

**Cutting ability:** 25 mm (1")

**Power:** 400 W (at nominal air supply conditions)\*

**Working pressure:** 6 bar\* ( $\pm 1$  bar) with lubricated air

**Air consumption:** 9 l/sec\*

**Net weight:** 1350 g

**Total weight (with packaging):** 3050 g

**Sound pressure:** 72 dB (EN ISO 15744)\*

**Vibrations at start up:** 1,36 m/sec<sup>2</sup> (ISO 8662)\*

**Minimum brightness for working operations:** LUX 200

**Temperature range:** 0 – 55 C

**Umidity range:** 10 – 95% without condensate

\* The reported data are collected at a pressure of 6 bar (ISO 2787: 1984), recommended operating pressure

\* Rasor recommend to use only dry air lubricated with special Rasor VG 5 pneumatic oil



### SAFETY

High-adjustable transparent fore blade protection

Fixed transparent back blade protection

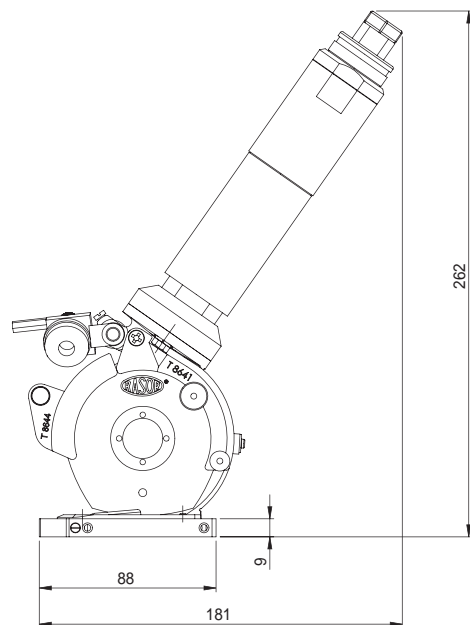

### DESCRIPTION

Model FP861A1 is a pneumatic cutting unit to cut textile and technical fabrics. The air compressed motor is wholly made by Rasor. Thanks to the latest generation mechanical and pneumatic components, the excellent turbine reaches a power of 400W at 20,000 RPM and a high torque. The motor diameter is now of 40mm only that is the smallest within its category. The rotor blades are made of VANESTAR® material which reduce to the minimum the weight and the friction. The installed knife of 86mm diameter 5-edges allow the cutting of any kind of material at the "flexible stage" up to a cutting thickness of 25mm. The high torque and the slow speed of the knife allow the cutting of rubber material with plastic base in the carpet and light flooring application. Especially suitable for transversal cutting model FP861A1 is suitable to be installed in small spaces thanks to the vertical position of the motor. This model is arranged with an anchor flange easy to be fitted on fixed or automatic stirrup. The mini low nylon base allows the easy movement of the cutting tool which can also be installed on sliding rails within a small space. The semi-automatic push button sharpening stone allows the sharpening of the knife edge to be done in less than 10 seconds without removing the knife. The small maintenance and small handling costs make the model FP861A1 the best solution for a powerful and reliable cutting within any O.E.M. application.



### ACCESSORIES

**Fast Connectors** P170, P171

**Regulators** P168

**Tube** P173

**Silencers** P029

**Lubricants** T107902

T107903

**Butterfly Keys** T107500

**Blocking Pins** T107600

**Gear Grease** T107900

**Metal Gloves** GMT-REV

### BLADES Ø 86 MM



86PHSS

86THSS

86PHSSTF

86THSSTF

86THSSTN

86TMD

TEXTILE

TECHNICAL  
TEXTILE

COMPOSITE

# FP100

PNEUMATIC CUTTING UNITS



## SPECIFICATIONS

- Blade diameter:** 100 mm (4"), with hard metal counterblade
- Blade descr.:** 10EHSS, 6-edges, HSS steel
- Blade speed:** 900 r.p.m.\*
- Cutting ability:** 35 mm (1.4")
- Power:** 400 W (at nominal air supply conditions)\*
- Working pressure:** 6 bar\* ( $\pm 1$  bar) with lubricated air
- Air consumption:** 9 l/sec\*
- Net weight:** 1350 g
- Total weight (with packaging):** 3050 g
- Sound pressure:** 72 dB (EN ISO 15744)\*
- Vibrations at start up:** 1,36 m/sec<sup>2</sup> (ISO 8662)\*
- Minimum brightness for working operations:** LUX 200
- Temperature range:** 0 – 55 C
- Umidity range:** 10 – 95% without condensate

\* This model is also available in left side version (specular) as model **FP100SX**

\* The reported data are collected at a pressure of 6 bar (ISO 2787: 1984), recommended operating pressure

\* Rasor recommend to use only dry air lubricated with special Rasor VG 5 pneumatic oil

## DESCRIPTION

Model FP100 is a pneumatic cutting unit for the cutting of textile and technical fabrics. The air compressed motor is wholly made by Rasor. Thanks to the latest generation mechanical and pneumatic components, the excellent turbine reaches a power of 400W at 20,000 RPM and a high torque. The motor diameter is now of 40mm only that is the smallest within its category. The rotor blades are made of VANESTAR® material which reduce to the minimum the weight and the friction. The installed knife of 100mm diameter 6-edges allow the cutting of any kind of material at the "flexible stage" up to a cutting thickness of 35mm. The high torque and the slow speed of the knife allow the cutting of rubber material with plastic base in the carpet and light flooring application. Especially suitable for transversal cutting model FP100 is suitable to be installed in small spaces thanks to the vertical position of the motor. This model is arranged with an anchor flange easy to be fitted on fixed or automatic stirrup. The Teflon® coated base allows the easy movement of the cutting tool which can also be installed on sliding rails within a small space. For continuous trimming process FP100 is also available as left hand side version (specular) as model FP100SX. The semi-automatic push button sharpening stone allows the sharpening of the knife edge to be done in less than 10 seconds without removing the knife. The small maintenance and small handling costs make the model FP100 the best solution for a powerful and reliable cutting within any O.E.M. application.

## SAFETY

- Height-adjustable transparent fore blade protection
- Fixed transparent back blade protection

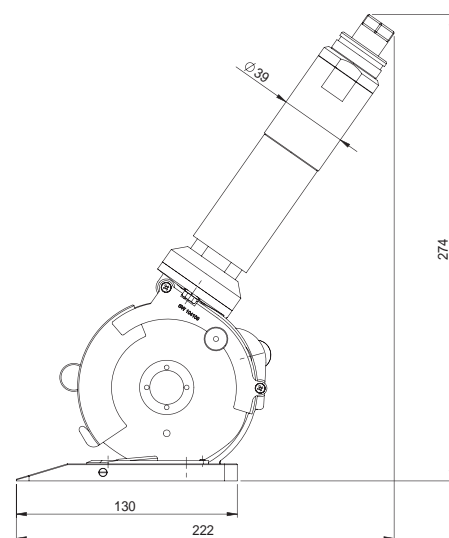

## BLADES Ø 100 MM



## ACCESSORIES

- Grinders** SW1086DIA
- Counterblades** SW1081DIA
- Fast Connectors** P170, P171
- Regulators** P168
- Tube** P173
- Silencers** P029
- Lubricants** T107902, T107903
- Butterfly Keys** T107500
- Blocking Pins** T107600
- Gear Grease** T107900
- Metal Gloves** GMT-REV

# FP100SX

## PNEUMATIC CUTTING UNITS

TEXTILE

TECHNICAL  
TEXTILE

COMPOSITE

### SPECIFICATIONS

**Blade diameter:** 100 mm (4"), with hard metal counterblade

**Blade descr.:** 10EHSS, 6-edges, HSS steel

**Blade speed:** 900 r.p.m.\*

**Cutting ability:** 35 mm (1.4")

**Power:** 400 W (at nominal air supply conditions)\*

**Working pressure:** 6 bar\* ( $\pm 1$  bar) with lubricated air

**Air consumption:** 9 l/sec\*

**Net weight:** 1350 g

**Total weight (with packaging):** 3050 g

**Sound pressure:** 72 dB (EN ISO 15744)\*

**Vibrations at start up:** 1,36 m/sec<sup>2</sup> (ISO 8662)\*

**Minimum brightness for working operations:** LUX 200

**Temperature range:** 0 – 55 C

**Umidity range:** 10 – 95% without condensate

\* This model is also available in right side version (specular) as model **FP100**

\* The reported data are collected at a pressure of 6 bar (ISO 2787: 1984), recommended operating pressure

\* Rasor recommend to use only dry air lubricated with special Rasor VG 5 pneumatic oil

### SAFETY

Height-adjustable transparent fore blade protection

Fixed transparent back blade protection

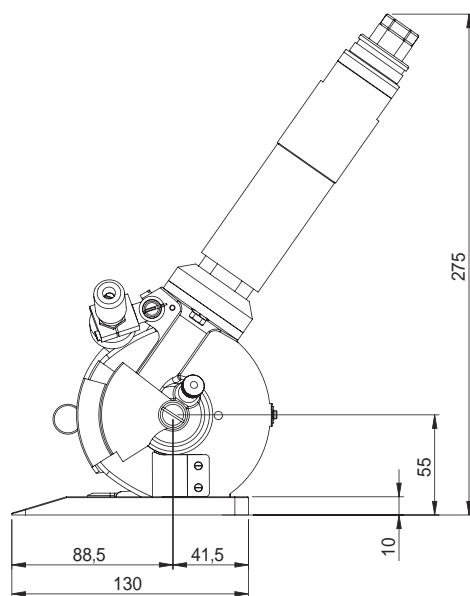

### DESCRIPTION

Model FP100SX is a pneumatic cutting unit for the cutting of textile and technical fabrics. The air compressed motor is wholly made by Rasor. Thanks to the latest generation mechanical and pneumatic components, the excellent turbine reaches a power of 400W at 20,000 RPM and a high torque. The motor diameter is now of 40mm only that is the smallest within its category. The rotor blades are made of VANESTAR® material which reduce to the minimum the weight and the friction. The installed knife of 100mm diameter 6-edges allow the cutting of any kind of material at the "flexible stage" up to a cutting thickness of 35mm. The high torque and the slow speed of the knife allow the cutting of rubber material with plastic base in the carpet and light flooring application. Especially suitable for transversal cutting model FP100SX is suitable to be installed in small spaces thanks to the vertical position of the motor. This model is arranged with an anchor flange easy to be fitted on fixed or automatic stirrup. The Teflon® coated base allows the easy movement of the cutting tool which can also be installed on sliding rails within a small space. For continuous trimming process FP100SX is also available as right hand side version (specular) as model FP100. The semi-automatic push button sharpening stone allows the sharpening of the knife edge to be done in less than 10 seconds without removing the knife. The small maintenance and small handling costs make the model FP100SX the best solution for a powerful and reliable cutting within any O.E.M. application.



### ACCESSORIES

**Grinders** SW1086DIA

**Counterblades** SW1081SDIA

**Fast Connectors** P170, P171

**Regulators** P168

**Tube** P173

**Silencers** P029

**Lubricants** T107902

T107903

**Butterfly Keys** T107500

**Blocking Pins** T107600

**Gear Grease** T107900

**Metal Gloves** GMT-REV

### BLADES Ø 100 MM



10EHSS



10CSW



10SEXTG



10EHSSTF



10EMD



TEXTILE

TECHNICAL  
TEXTILE

COMPOSITE

# FP120

PNEUMATIC CUTTING UNITS



## SPECIFICATIONS

- Blade diameter:** 120 mm (4.7"), with hard metal counterblade
- Blade descr.:** 12SHSS, 8-edges, HSS steel
- Blade speed:** 700 r.p.m.\*
- Cutting ability:** 50 mm (2")
- Power:** 800 W (at nominal air supply conditions)\*
- Working pressure:** 6 bar\* (±1 bar) with lubricated air
- Air consumption:** 18 l/sec\*
- Net weight:** 4300 g
- Total weight (with packaging):** 6000 g
- Sound pressure:** 72 dB (EN ISO 15744)\*
- Vibrations at start up:** 1,36 m/sec<sup>2</sup> (ISO 8662)\*
- Minimum brightness for working operations:** LUX 200
- Temperature range:** 0 – 55 C
- Umidity range:** 10 – 95% without condensate

\* This model is also available in left side version (specular) as model **FP120SX**

\* The reported data are collected at a pressure of 6 bar (ISO 2787: 1984), recommended operating pressure

\* Rasor recommend to use only dry air lubricated with special Rasor VG 5 pneumatic oil

## SAFETY

- High-adjustable transparent fore blade protection
- Fixed transparent back blade protection

## DESCRIPTION

Model FP120 is a pneumatic cutting unit for cutting textile and technical fabrics having high thickness even with multi-layer. This is the most powerful cutting unit that Rasor has ever produced. The air compressed motor is wholly made by Rasor. Thanks to the latest generation mechanical and pneumatic components, the excellent turbine reaches a power of 800W at 15,500 RPM and a very high torque. The installed knife of 120mm diameter 8-edges allow the cutting of any kind of material at the "flexible stage" up to a cutting thickness of 50mm. The high torque and the slow speed of the knife allow the cutting of rubber material with plastic base in the carpet and light flooring application. FP120 is perfect to cut rubber, composite and plastics material. Especially suitable for the transversal cut to be installed in small spaces and it is arranged with an anchor flange easy to be fitted on fixed or automatic stirrup. The Teflon® coated aluminium base reduce the friction and to allow the easy movement of the cutting tool which can also be installed on sliding rails within a small space. For the continuous trimming processes FP120 is also available in left side version (specular) as model FP120SX. FP120 simply equal to top power and top performance for your O.E.M. application.

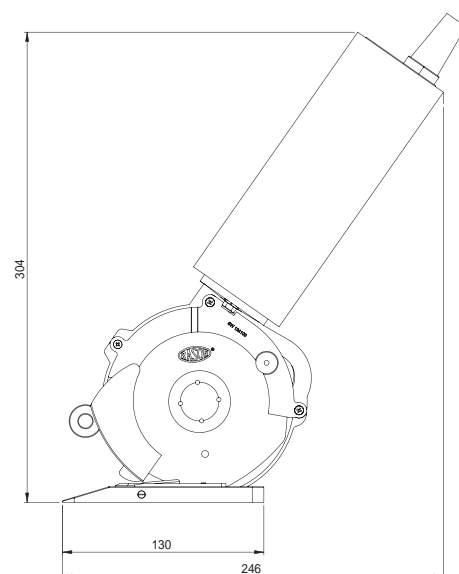

## BLADES Ø 120 MM



12SHSS    12CSW    12DHSS    12SHSSTF    12SHSSTN    12DHSSTN    12SMD

## ACCESSORIES

- Grinders** SW1286DIA
- Counterblades** SW1081DIA
- Fast Connectors** P170, P171
- Regulators** P168
- Tube** P173
- Lubricants** T107902
- T107903**
- Butterfly Keys** T107500
- Blocking Pins** T107600
- Gear Grease** T107900
- Metal Gloves** GMT-REV

# FP120SX

## PNEUMATIC CUTTING UNITS

TEXTILE

TECHNICAL  
TEXTILE

COMPOSITE

### SPECIFICATIONS

**Blade diameter:** 120 mm (4.7"), with hard metal counterblade

**Blade descr.:** 12SHSS, 8-edges, HSS steel

**Blade speed:** 700 r.p.m.\*

**Cutting ability:** 50 mm (2")

**Power:** 800 W (at nominal air supply conditions)\*

**Working pressure:** 6 bar\* ( $\pm 1$  bar) with lubricated air

**Air consumption:** 18 l/sec\*

**Net weight:** 4300 g

**Total weight (with packaging):** 6000 g

**Sound pressure:** 72 dB (EN ISO 15744)\*

**Vibrations at start up:** 1,36 m/sec<sup>2</sup> (ISO 8662)\*

**Minimum brightness for working operations:** LUX 200

**Temperature range:** 0 – 55 C

**Umidity range:** 10 – 95% without condensate

\* This model is also available in right side version (specular) as model **FP120**

\* The reported data are collected at a pressure of 6 bar (ISO 2787: 1984), recommended operating pressure

\* Rasor recommend to use only dry air lubricated with special Rasor VG 5 pneumatic oil

### SAFETY

Height-adjustable transparent fore blade protection

Fixed transparent back blade protection

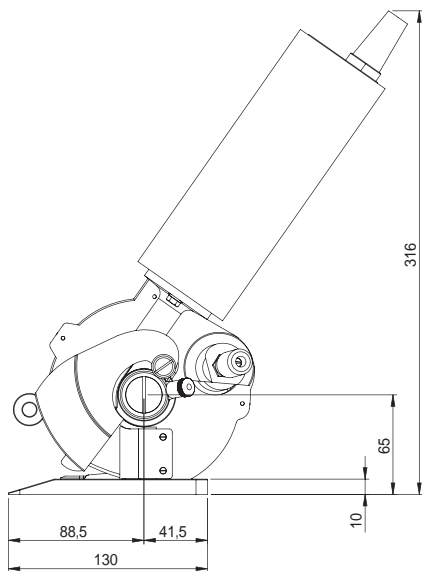

### DESCRIPTION

Model FP120SX is a pneumatic cutting unit for cutting textile and technical fabrics having high thickness even with multi-layer. This is the most powerful cutting unit that Rasor has ever produced. The air compressed motor is wholly made by Rasor. Thanks to the latest generation mechanical and pneumatic components, the excellent turbine reaches a power of 800W at 15,500 RPM and a very high torque. The installed knife of 120mm diameter 8-edges allow the cutting of any kind of material at the "flexible stage" up to a cutting thickness of 50 mm. The high torque and the slow speed of the knife allow the cutting of rubber material with plastic base in the carpet and light flooring application. FP120SX is perfect to cut rubber, composite and plastics material. Especially suitable for the transversal cut to be installed in small spaces and it is arranged with an anchor flange easy to be fitted on fixed or automatic stirrup. The Teflon® coated aluminium base reduce the friction and to allow the easy movement of the cutting tool which can also be installed on sliding rails within a small space. For the continuous trimming processes FP120SX is also available in right side version (specular) as model FP120. FP120SX simply equal to top power and top performance for your O.E.M. application.



### ACCESSORIES

**Grinders** SW1286DIA

**Counterblades** SW1081SDIA

**Fast Connectors** P170, P171

**Regulators** P168

**Tube** P173

**Lubricants** T107902,

T107903

**Butterfly Keys** T107500

**Blocking Pins** T107600

**Gear Grease** T107900

**Metal Gloves** GMT-REV

### BLADES Ø 120 MM



12SHSS

12CSW

12DHSS

12SHSSTF

12SHSSTN

12DHSSTN

12SMD



TEXTILE

TECHNICAL  
TEXTILE

COMPOSITE

# FP120M

PNEUMATIC CUTTING UNITS

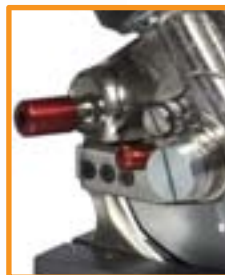

## SPECIFICATIONS

- Blade diameter:** 120 mm (4.7"), with hard metal counterblade
- Blade descr.:** 12SHSS, 8-edges, HSS steel
- Blade speed:** 700 r.p.m.\*
- Cutting ability:** 50 mm (2")
- Power:** 800 W (at nominal air supply conditions)\*
- Working pressure:** 6 bar\* (±1 bar) with lubricated air
- Air consumption:** 18 l/sec\*
- Net weight:** 4300 g
- Total weight (with packaging):** 6000 g
- Sound pressure:** 72 dB (EN ISO 15744)\*
- Vibrations at start up:** 1,36 m/sec<sup>2</sup> (ISO 8662)\*
- Minimum brightness for working operations:** LUX 200
- Temperature range:** 0 – 55 C
- Umidity range:** 10 – 95% without condensate

\* This model is also available in left side version (specular) as model **FP120SM**  
 \* The reported data are collected at a pressure of 6 bar (ISO 2787: 1984), recommended operating pressure  
 \* Rasor recommend to use only dry air lubricated with special Rasor VG 5 pneumatic oil

## DESCRIPTION

Model FP120M is a pneumatic cutting unit for cutting textile, technical fabrics and composite material having high thickness even with multi-layer. This is the most powerful cutting unit that Rasor have ever produced. The air compressed motor is wholly made by Rasor. Thanks to the latest generation mechanical and pneumatic components, the excellent turbine reaches a power of 800 W at 15.500 RPM and a very high torque. Recently developed this model gives its excellency to the new geometry of the motor housing of Monster series. Differently from the other models of cutting units FP120M has the motor housing held by a central foot fitted behind the blade in central position. This system spreads the shearing stress and the necessary stress to move the machine through the fabrics on both sides of the cutter and cut is so done perfectly straight and smooth. The knife is half-free on both sides to avoid winding problems even with tough fibers. FP120M is especially suitable to cut composite materials like glass fiber, carbon fiber and kevlar. The installed knife of 120 mm diameter 8-edges allow the cutting of any kind of material at the "flexible stage" up to a cutting thickness of 50mm. The push button sharpening stone allows the sharpening of the knife edge to be done in less than 10 seconds without removing the knife. The high torque and the slow speed of the knife allow the cutting of rubber material with plastic base in the carpet and light flooring application. FP120M is especially suitable for the transversal cut and to be installed in small spaces and it is arranged with an anchor flange easy to be fitted on fixed or automatic stirrup. The Teflon® coated aluminium base reduce the friction between the foot and the material and allow the easy forward movement even for an installation sliding rails. For the continuous trimming process FP120M is also available in left side version (specular) as model FP120SM. FP120M simply equal to top power and top performance for your O.E.M. application.

## SAFETY

- High-adjustable transparent fore blade protection
- Fixed transparent back blade protection

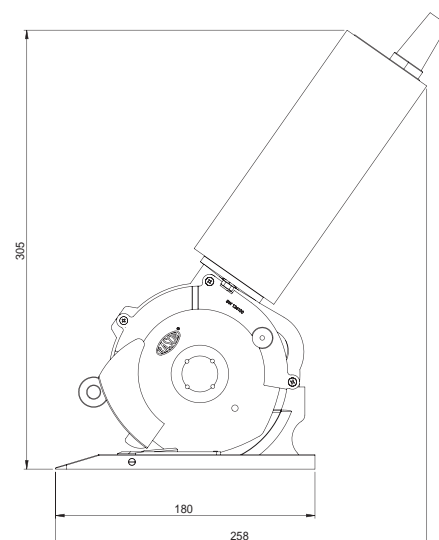

## BLADES Ø 120 MM



## ACCESSORIES

- Grinders** SW1286DIA 107903
- Counterblades** SW1081DIA **Butterfly Keys** T107500
- Fast Connectors** P170, P171 **Blocking Pins** T107600
- Regulators** P168 **Gear Grease** T107900
- Tube** P173 **Metal Gloves** GMT-REV
- Lubricants** T107902,

# FP120SM

## PNEUMATIC CUTTING UNITS

TEXTILE

TECHNICAL  
TEXTILE

COMPOSITE

### SPECIFICATIONS

**Blade diameter:** 120 mm (4.7"), with hard metal counterblade

**Blade descr.:** 12SHSS, 8-edges, HSS steel

**Blade speed:** 700 r.p.m.\*

**Cutting ability:** 50 mm (2")

**Power:** 800 W (at nominal air supply conditions)\*

**Working pressure:** 6 bar\* ( $\pm 1$  bar) with lubricated air

**Air consumption:** 18 l/sec\*

**Net weight:** 4300 g

**Total weight (with packaging):** 6000 g

**Sound pressure:** 72 dB (EN ISO 15744)\*

**Vibrations at start up:** 1,36 m/sec<sup>2</sup> (ISO 8662)\*

**Minimum brightness for working operations:** LUX 200

**Temperature range:** 0 – 55 C

**Umidity range:** 10 – 95% without condensate

\* This model is also available in right side version (specular) as model **FP120M**

\* The reported data are collected at a pressure of 6 bar (ISO 2787: 1984), recommended operating pressure

\* Rasor recommend to use only dry air lubricated with special Rasor VG 5 pneumatic oil



### SAFETY

Height-adjustable transparent fore blade protection

Fixed transparent back blade protection

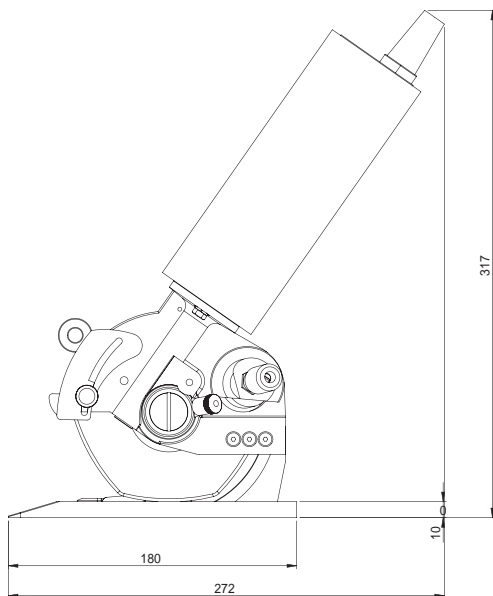

### DESCRIPTION

Model FP120SM is a pneumatic cutting unit for cutting textile, technical fabrics and composite material having high thickness even with multi-layer. This is the most powerful cutting unit that Rasor have ever produced. The air compressed motor is wholly made by Rasor. Thanks to the latest generation mechanical and pneumatic components, the excellent turbine reaches a power of 800 W at 15.500 RPM and a very high torque. Recently developed this model gives its excellency to the new geometry of the motor housing of Monster series. Differently from the other models of cutting units FP120SM has the motor housing held by a central foot fitted behind the blade in central position. This system spreads the shearing stress and the necessary stress to move the machine through the fabrics on both sides of the cutter and cut is so done perfectly straight and smooth. The knife is half-free on both sides to avoid winding problems even with tough fibers. FP120SM is especially suitable to cut composite materials like glass fiber, carbon fiber and kevlar. The installed knife of 120 mm diameter 8-edges allow the cutting of any kind of material at the "flexible stage" up to a cutting thickness of 50mm. The push button sharpening stone allows the sharpening of the knife edge to be done in less than 10 seconds without removing the knife. The high torque and the slow speed of the knife allow the cutting of rubber material with plastic base in the carpet and light flooring application. FP120SM is especially suitable for the transversal cut and to be installed in small spaces and it is arranged with an anchor flange easy to be fitted on fixed or automatic stirrup. The Teflon® coated aluminium base reduce the friction between the foot and the material and allow the easy forward movement even for an installation sliding rails. For the continuous trimming process FP120SM is also available in left right version (specular) as model FP120M. FP120SM simply equal to top power and top performance for your O.E.M. application.



### ACCESSORIES

**Grinders** SW1286DIA

**Counterblades** SW1081DIA

**Fast Connectors** P170, P171

**Regulators** P168

**Tube** P173

**Lubricants** T107902/T107903

**Butterfly Keys** T107500

**Blocking Pins** T107600

**Gear Grease** T107900

**Metal Gloves** GMT-REV

### BLADES Ø 120 MM



12SHSS

12CSW

12DHSS

12SHSSTF

12SHSSTN

12DHSSTN

12SMD



TEXTILE

TECHNICAL  
TEXTILE

COMPOSITE

# FP120DT

PNEUMATIC CUTTING UNITS



BI-DIRECTIONAL



## SPECIFICATIONS

- Blade diameter:** 120 mm (4.7"), with double hard metal counterblade
- Blade descr.:** 12SHSS, 8-edges, HSS steel
- Blade speed:** 700 r.p.m.\*
- Cutting ability:** 50 mm (2"), bidirectional
- Power:** 645 W (at nominal air supply conditions)\*
- Working pressure:** 6 bar\* ( $\pm 1$  bar) with lubricated air
- Air consumption:** 18 l/sec\*
- Net weight:** 4350 g
- Total weight (with packaging):** 6050 g
- Sound pressure:** 72 dB (EN ISO 15744)\*
- Vibrations at start up:** 1,36 m/sec<sup>2</sup> (ISO 8662)\*
- Minimum brightness for working operations:** LUX 200
- Temperature range:** 0 – 55 C
- Umidity range:** 10 – 95% without condensate

\* The reported data are collected at a pressure of 6 bar (ISO 2787: 1984), recommended operating pressure

\* Razor recommend to use only dry air lubricated with special Rasor VG 5 pneumatic oil



## SAFETY

- High-adjustable transparent fore blade protection
- Fixed transparent back blade protection

## DESCRIPTION

Model FP120DT is a pneumatic cutting unit for cutting textile, technical fabrics and composite material having high thickness even with multi-layer. Thanks to the double carbide counter-blade FP120DT is able to cut on both directions (through a double air inlet). This peculiarity allow to save a run and time during the cross-cut process. The air compressed motor is made of the latest generation mechanical and pneumatic components, the excellent turbine reaches a power of 645 W at 15,500 RPM and a very high torque. FP120DT has a 120mm 8-edges knife which allows to cut any kind of materiale at the "flexible stage" up to a cutting thickness of 50mm. The push button sharpening stone allows the sharpening of the knife edge to be done in less than 10 seconds without removing the knife. The high torque and the slow speed of the knife allow the cutting of rubber material with plastic base in the carpet and light flooring application. FP120DT is especially suitable for the transversal cut and to be installed in small spaces and it is arranged with an anchor flange easy to be fitted on fixed or automatic stirrup. The aluminium Teflon® coated base reduce the friction between the foot and the material and allow the easy forward movement even for an installation sliding rails. The power and bidirectional feature make FP120DT the best solution for the most difficult O.E.M. application.

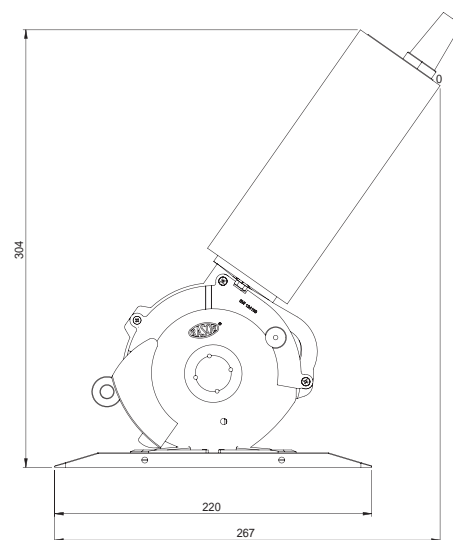

## BLADES Ø 120 MM



12SHSS 12CSW 12DHSS 12SHSSTF 12SHSSTN 12DHSSTN 12SMD

## ACCESSORIES

- Grinders** SW1286DIA
- Counterblades** SW1081DIA
- SW1081SDIA
- Fast Connectors** P170, P171
- Regulators** P168
- Tube** P173

- Lubricants** T107902
- T107903
- Butterfly Keys** T107500
- Blocking Pins** T107600
- Gear Grease** T107900
- Metal Gloves** GMT-REV







A close-up, macro photograph of a woven fabric. The fabric features a complex pattern of blue, white, and orange threads. The orange threads are thicker and more prominent, forming a central band that curves across the frame. The blue and white threads are finer and form a dense, textured background. The lighting is dramatic, highlighting the individual fibers and the intricate weave of the material.

**SPEED &  
PRECISION**

**SinglePhase cutting units**







TEXTILE

TECHNICAL  
TEXTILE

COMPOSITE

# D86PS

SINGLEPHASE CUTTING UNITS



## SPECIFICATIONS

- Blade diameter:** 86 mm (3.4") with hard metal counterblade
- Blade descr.:** 86PHSS, 5-edges, HSS steel
- Blade speed:** 850 r.p.m.
- Cutting ability:** 25 mm (1")
- Power:** singlephase – 90 W
- Max absorption:** 2 A
- Net weight (with power supply cord):** 2900 g
- Total weight (with packaging):** 4600 g
- Electric cable length:** 1.5 mt (with no plug)
- Minimum brightness for working operations:** 200 LUX
- Vibrations at start up:** < 2.5 m/sec<sup>2</sup>
- Temperature range:** 0 – 55 C
- Umidity range:** 10 – 95% without condensate

## SAFETY

- Main power switch with Led indicator
- Height-adjustable transparent fore blade protection
- Fixed transparent back blade protection
- Double electric insulation

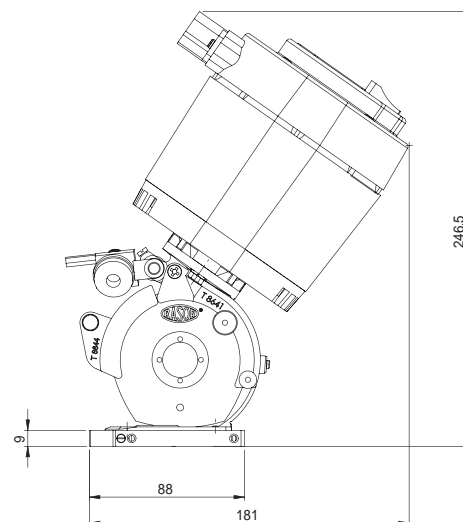
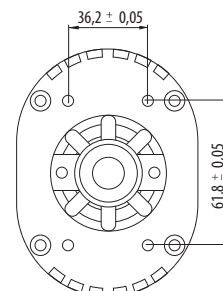

## DESCRIPTION

D86PS is the smallest single-phase cutting unit with a wide counterblade. For over 20 years within the market, it is installed on the most popular tenters models. D86PS weighs less than 3Kilos within a limited overall dimensions. The 5-edge knife assure a sharp and precise cut without rag grinding. The semiautomatic stone sharpening system allows the sharpening of the knife edge to be done in only 10 seconds without removing the knife. This model is widely applied in textile field and in leather and light carpets industries. It is especially suitable for the transversal cut due to its anchor flange which allows an easy fitting on fixed or automatic stirrup. The mini nylon base of This cutting unit allows its installation on sliding rails within a short space. The few maintenance and low operation cost make D86PS to be the cheapest and most reliable cutting solution in any of your O.E.M. application.



## BLADES Ø 86 MM



86PHSS

86THSS

86PHSSTF

86THSSTF

86THSSTN

86TMD

## ACCESSORIES

- Counterblades SW1081DIA
- Rail G30-03
- Trailers C30-03, C30-0301
- Stopper S30-03
- Remote Handles 105MA
- Butterfly Keys T107500

- Blocking Pins T107600
- Gear Grease T107900
- Metal Gloves GMT-REV

# SW100S

## SINGLEPHASE CUTTING UNITS

### SPECIFICATIONS

**Blade diameter:** 100 mm (4"), with hard metal counterblade

**Blade descr.:** 10EHSS, 6-edges, HSS steel

**Blade speed:** 850 r.p.m.

**Cutting ability:** 35 mm (1.4")

**Power:** singlephase – 90 W

**Max absorption:** 2 A

**Net weight (with power supply cord):** 2650 g

**Total weight (with packaging):** 4750 g

**Electric cable length:** 1.5 mt (with no plug)

**Minimum brightness for working operations:** 200 LUX

**Vibrations at start up:** < 2.5 m/sec<sup>2</sup>

**Temperature range:** 0 – 55 C

**Umidity range:** 10 – 95% without condensate

\* This model is also available in left side version (specular) as model **SW10SS**

### SAFETY

Main power switch with Led indicator

Height-adjustable transparent fore blade protection

Fixed transparent back blade protection

Double electric insulation

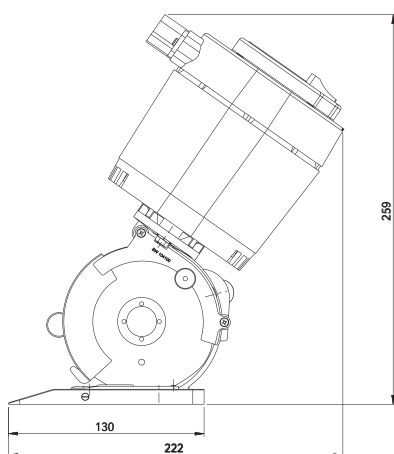
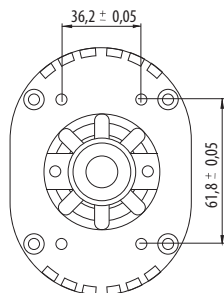

### DESCRIPTION

For over 30 years within the market, SW100S is the most efficient and popular single-phase cutting unit in textile and technical fabrics fields. It reaches the highest level of technology and safety and guarantee power and reliability in less than 3 Kg. weight. The combination between blade and counterblade allows a sharp and precise cut without any rag grinding. The 90Watt balanced and silenced motor combined with a high resistance bronze/steel gear couplings create a long lasting stability. The 6-edge 100mm diameter knife allows to cut any fabric up to 35mm thickness. SW100S is especially suitable to the transversal cut because it is arranged with an anchor flange easy to be fitted on fixed or automatic stirrup. The base is Teflon® coated so to allow an easy feed by reducing the friction between the base and the fabric and it is possible to install this cutting unit on sliding rails within a minimum space. The push button sharpening stone system allows the sharpening of the knife edge in less than 10 sec. without removing the knife. For the continuous trimming process SW100S is also available in left side version (specular) as model SW10SS. The few maintenance and low operation cost make model SW100S to be the cheapest and most reliable cutting solution in any of your O.E.M. application.



### ACCESSORIES

**Grinders** SW1086DIA

**Counterblades** SW1081DIA

**Rail** G30-03

**Trailers** C30-03, C30-0301

**Stopper** S30-03

**Remote Handles** 10SMA

**Butterfly Keys** T107500

**Blocking Pins** T107600

**Gear Grease** T107900

**Metal Gloves** GMT-REV

### BLADES Ø 100 MM



10EHSS



10CSW



10SEXTG



10EHSSTF



10EMD



TEXTILE

TECHNICAL  
TEXTILE

COMPOSITE

# SW10SS

SINGLEPHASE CUTTING UNITS



## SPECIFICATIONS

- Blade diameter:** 100 mm (4"), with hard metal counterblade
- Blade descr.:** 10EHSS, 6-edges, HSS steel
- Blade speed:** 850 r.p.m.
- Cutting ability:** 35 mm (1.4")
- Power:** singlephase – 90 W
- Max absorption:** 2 A
- Net weight (with power supply cord):** 2650 g
- Total weight (with packaging):** 4750 g
- Electric cable length:** 1.5 mt (with no plug)
- Minimum brightness for working operations:** 200 LUX
- Vibrations at start up:** < 2.5 m/sec<sup>2</sup>
- Temperature range:** 0 – 55 C
- Umidity range:** 10 – 95% without condensate

\* This model is also available in right side version (specular) as model **SW100S**

## SAFETY

- Main power switch with Led indicator
- High-adjustable trasparent fore blade protection
- Fixed trasparent back blade protection
- Double electric insulation

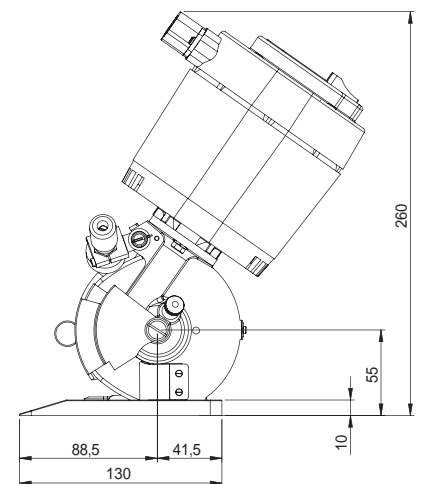
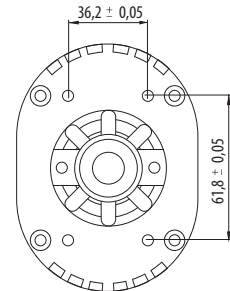

## DESCRIPTION

For over 30 years within the market, SW10SS is the most efficient and popular single-phase cutting unit in textile and technical fabrics fields. It reaches the highest level of technology and safety and guarantee power and reliability in less than 3 Kg. weight. The combination between blade and counteblade allows a sharp and precise cut without any rag grinding. The 90Watt balanced and silenced motor combined with a high resistance bronze/steel gear couplings create a long lasting stability. The 6-edge 100mm diameter knife allows to cut any fabric up to 35mm thickness. SW10SS is especially suitable to the transversal cut because it is arranged with an anchor flange easy to be fitted on fixed or automatic stirrup. The base is Teflon® coated so to allow an easy feed by reducing the friction between the base and the fabric and It is possible to install this cutting unit on slinding rails within a minimum space. The push button sharpening stone system allows the sharpening of the knife edge in less than 10 sec. without removing the knife. For the continuous trimming process SW10SS is also available in right side version (specular) as model SW100S. The few maintenance and low operation cost make model SW100S to be the cheapest and most reliable cutting solution in any of your O.E.M. application.



## BLADES Ø 100 MM



## ACCESSORIES

- Grinders SW1086DIA
- Counterblades SW1081SDIA
- Rail G30-03
- Trailers C30-03, C30-0301
- Stopper S30-03
- Remote Handles 10SMA
- Butterfly Keys T107500
- Blocking Pins T107600
- Gear Grease T107900
- Metal Gloves GMT-REV

# SW12S

## SINGLEPHASE CUTTING UNITS

### SPECIFICATIONS

**Blade diameter:** 120 mm (4.7"), with hard metal counterblade

**Blade descr.:** 12SHSS, 8-edges, HSS steel

**Blade speed:** 850 r.p.m.

**Cutting ability:** 50 mm (2")

**Power:** singlephase – 180 W

**Max absorption:** 2.5 A

**Net weight (with power supply cord):** 4500 g

**Total weight (with packaging):** 6200 g

**Electric cable length:** 1.5 mt (with no plug)

**Minimum brightness for working operations:** 200 LUX

**Vibrations at start up:** < 2.5 m/sec<sup>2</sup>

**Temperature range:** 0 – 55 C

**Umidity range:** 10 – 95% without condensate

\* This model is also available in left side version (specular) as model **SW12SSX**

### SAFETY

Main power switch with Led indicator

Heigh-adjustable trasparent fore blade protection

Fixed trasparent back blade protection

Double electric insulation

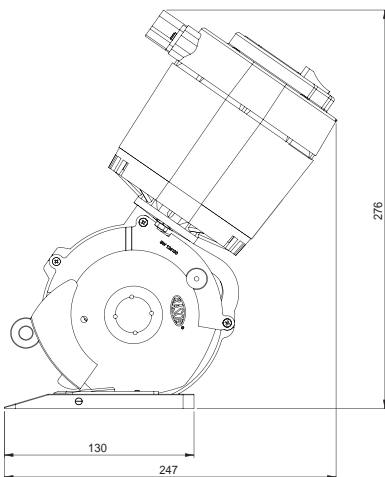
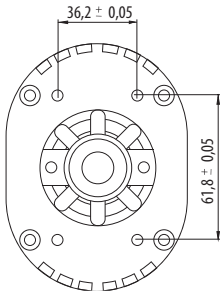

### DESCRIPTION

SW12S is a cutting unit for high thickness suitable for application in textile and technical fabrics fields. It reaches the highest level in technology and safety. It weighs 3Kg only but guarantee power and high thickness cutting reliability. The combination system of blade and countblade allows sharp and precise cut without rag grinding. Its 180Watt balanced and silenced motor combined with high resistance bronze/steel gear couplings create a long lasting stability. The 8-edge 120mm diameter knife allows the cut of any fabric up to 50mm thickness even in multiple layers. SW12S base is Teflon® coated to be friction-free between the base and the fabric. It is possible to install this cutting unit on sliding rails within a minimum space. The push button sharpening stone system allows the sharpening of the knife edge in less than 10 seconds without removing the knife. This model is especially suitable to the transversal cut being arranged with an anchor flange which allows an easy fit on fixed or automatic stirrup. For the continuous trimming process model SW12S is also available in left side version (specular) as model SW12SSX.



### ACCESSORIES

**Grinders** SW1286DIA

**Counterblades** SW1081DIA

**Rail** G30-03

**Trailers** C30-03, C30-0301

**Stopper** S30-03

**Remote Handles** 10SMA

**Butterfly Keys** T107500

**Blocking Pins** T107600

**Gear Grease** T107900

**Metal Gloves** GMT-REV

### BLADES Ø 120 MM



12SHSS

12CSW

12DHSS

12SHSSTF

12SHSSTN

12DHSSTN

12SMD



TEXTILE

TECHNICAL  
TEXTILE

COMPOSITE

# SW12SSX

SINGLEPHASE CUTTING UNITS



## SPECIFICATIONS

- Blade diameter:** 120 mm (4.7"), with hard metal counterblade
- Blade descr.:** 12SHSS, 8-edges, HSS steel
- Blade speed:** 850 r.p.m.
- Cutting ability:** 50 mm (2")
- Power:** singlephase – 180 W
- Max absorption:** 2.5 A
- Net weight (with power supply cord):** 4500 g
- Total weight (with packaging):** 6200 g
- Electric cable length:** 1.5 mt (with no plug)
- Minimum brightness for working operations:** 200 LUX
- Vibrations at start up:** < 2.5 m/sec<sup>2</sup>
- Temperature range:** 0 – 55 C
- Umidity range:** 10 – 95% without condensate

\* This model is also available in right side version (specular) as model **SW12S**

## SAFETY

- Main power switch with Led indicator
- Height-adjustable transparent fore blade protection
- Fixed transparent back blade protection
- Double electric insulation

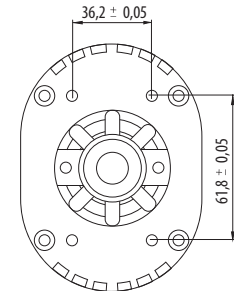

## DESCRIPTION

SW12SSX is a cutting unit for high thickness suitable for application in textile and technical fabrics fields. It reaches the highest level in technology and safety. It weighs 3Kg only but guarantee power and high thickness cutting reliability. The combination system of blade and counterblade allows sharp and precise cut without rag grinding. Its 180Watt balanced and silenced motor combined with high resistance bronze/steel gear couplings create a long lasting stability. The 8-edge 120mm diameter knife allows the cut of any fabric up to 50mm thickness even in multiple layers. SW12SSX base is Teflon® coated to be friction-free between the base and the fabric. It is possible to install this cutting unit on sliding rails within a minimum space. The push button sharpening stone system allows the sharpening of the knife edge in less than 10 seconds without removing the knife. This model is especially suitable to the transversal cut being arranged with an anchor flange which allows an easy fit on fixed or automatic stirrup. For the continuous trimming process model SW12SSX is also available in right side version (specular) as model SW12S.

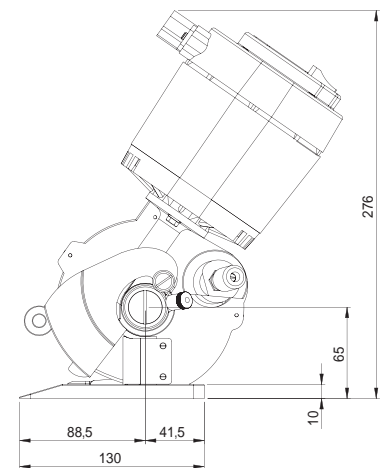

## BLADES Ø 120 MM



12SHSS 12CSW 12DHSS 12SHSSTF 12SHSSTN 12DHSSTN 12SMD

## ACCESSORIES

- Grinders SW1286DIA
- Counterblades SW1081SDIA
- Rail G30-03
- Trailers C30-03, C30-0301
- Stopper S30-03
- Remote Handles 10SMA

- Butterfly Keys T107500
- Blocking Pins T107600
- Gear Grease T107900
- Metal Gloves GMT-REV

# SW12SM

## SINGLEPHASE CUTTING UNITS

TECHNICAL  
TEXTILE

COMPOSITE

### SPECIFICATIONS

- Blade diameter:** 120 mm (4.7"), with hard metal counterblade
- Blade descr.:** 12SHSS, 8-edges, HSS steel
- Blade speed:** 550 r.p.m.
- Cutting ability:** 50 mm (2")
- Power:** singlephase – 350 W
- Max absorption:** 2.5 A
- Net weight (with power supply cord):** 4500 g
- Total weight (with packaging):** 6200 g
- Electric cable length:** 1.5 mt (with no plug)
- Minimum brightness for working operations:** 200 LUX
- Vibrations at start up:** < 2.5 m/sec<sup>2</sup>
- Temperature range:** 0 – 55 C
- Umidity range:** 10 – 95% without condensate

\* This model is also available in left side version (specular) as model **SW12SSM**

### SAFETY

- Main power switch with Led indicator
- Height-adjustable transparent fore blade protection
- Fixed transparent back blade protection
- Double electric insulation

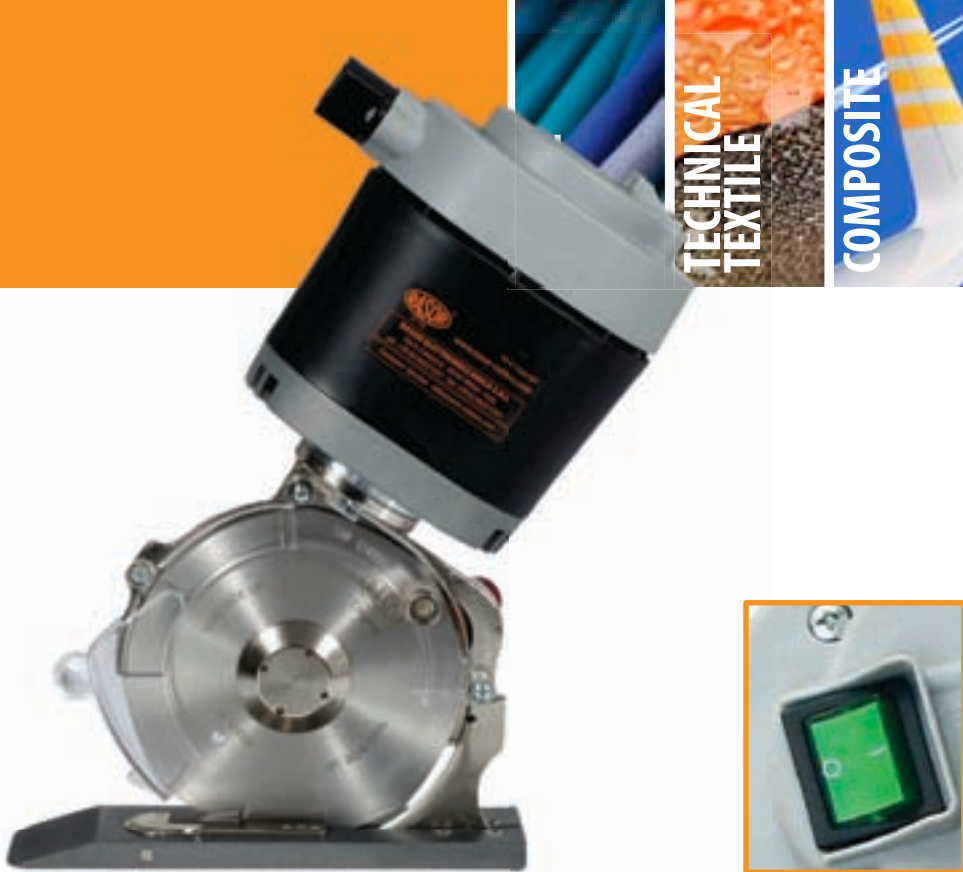
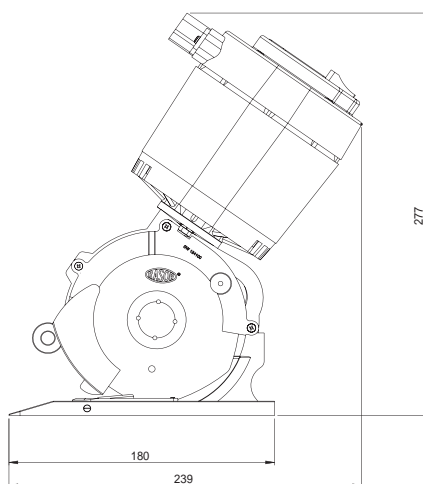
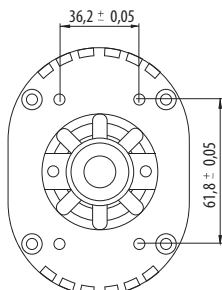

### DESCRIPTION

SW12SM is a new generation cutting unit for high thickness. Launched on the market only a couple of months ago SW12SM gives its excellency to the new geometry of the motor housing of Monster series. The difference between SW12SM and the other Rasor's cutting units is given by its motor housing held by a central foot fitted behind the blade in central position. This system spreads the shearing stress and the necessary stress to move the machine through the fabrics on both sides of the cutter and cut is so done perfectly straight and smooth. The knife is half-free on both sides to avoid winding problems even with tough fibers. SW12SM is especially suitable to cut composite materials like glass fiber, carbon fiber and kevlar. The impressive 350 Watt motor combined with a bronze/steel coupling gear develop a very high torque. SW12SM is able to cut any material at the "soft" stage up to maximum 50 mm of thickness. High torque combined with the slow RPM of the knife allow to cut even rubber materials and plastic based material in the field of carpets and industrial flooring in multi-layers. The push button sharpening stone allows the sharpening of the knife edge to be done in less than 10 seconds without removing the knife. The aluminium cutting base is Teflon® coated to allow the easy run of the machine and the reduction of the friction between the base and the material. SW12SM is especially suitable for the transversal cut and it is arranged with an anchor flange to be easily adjusted on fixed or automated hanger. For 24-hours a day trimming SW12SM is also available in left version (specular) as model SW12SSM.



### ACCESSORIES

- Grinders** SW1286DIA
- Counterblades** SW1081DIA
- Rail** G30-03
- Trailers** C30-03, C30-0301
- C30-0302**
- Stopper** S30-03
- Remote Handles** 10SMA
- Butterfly Keys** T107500
- Blocking Pins** T107600
- Gear Grease** T107900
- Metal Gloves** GMT-REV

### BLADES Ø 120 MM



12SHSS

12CSW

12DHSS

12SHSSTF

12SHSSTN

12DHSSTN

12SMD



TEXTILE

TECHNICAL  
TEXTILE

OSITE

# SW12SSM

SINGLEPHASE CUTTING UNITS

## SPECIFICATIONS

- Blade diameter:** 120 mm (4.7"), with hard metal counterblade
- Blade descr.:** 12SHSS, 8-edges, HSS steel
- Blade speed:** 550 r.p.m.
- Cutting ability:** 50 mm (2")
- Power:** singlephase – 350 W
- Max absorption:** 2.5 A
- Net weight (with power supply cord):** 4500 g
- Total weight (with packaging):** 6200 g
- Electric cable length:** 1.5 mt (with no plug)
- Minimum brightness for working operations:** 200 LUX
- Vibrations at start up:** < 2.5 m/sec<sup>2</sup>
- Temperature range:** 0 – 55 C
- Umidity range:** 10 – 95% without condensate

\* This model is also available in right side version (specular) as model **SW12SM**

## SAFETY

- Main power switch with Led indicator
- High-adjustable transparent fore blade protection
- Fixed transparent back blade protection
- Double electric insulation

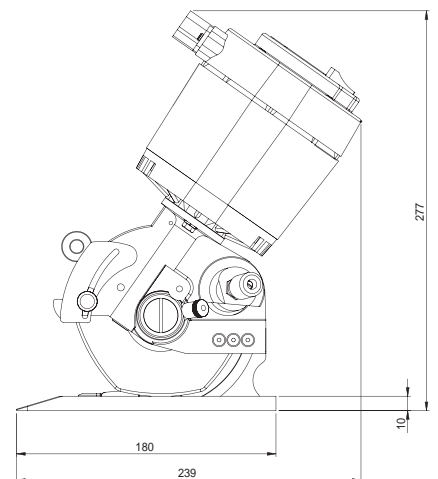
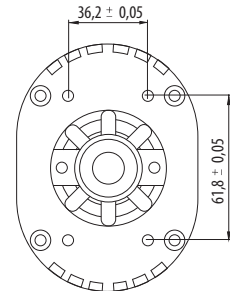

## DESCRIPTION

SW12SSM is a new generation cutting unit for high thickness. Launched on the market only a couple of months ago SW12SSM gives its excellency to the new geometry of the motor housing of Monster series. The difference between SW12SSM and the other Rasor's cutting units is given by its motor housing held by a central foot fitted behind the blade in central position. This system spreads the shearing stress and the necessary stress to move the machine through the fabrics on both sides of the cutter and cut is so done perfectly straight and smooth. The knife is half-free on both sides to avoid winding problems even with tough fibers. SW12SSM is especially suitable to cut composite materials like glass fiber, carbon fiber and kevlar. The impressive 350 Watt motor combined with a bronze/steel coupling gear develop a very high torque. SW12SSM is able to cut any material at the "soft" stage up to maximum 50 mm of thickness. High torque combined with the slow RPM of the knife allow to cut even rubber materials and plastic based material in the field of carpets and industrial flooring in multi-layers. The push button sharpening stone allows the sharpening of the knife edge to be done in less than 10 seconds without removing the knife. The aluminium cutting base is Teflon® coated to allow the easy run of the machine and the reduction of the friction between the base and the material. SW12SSM is especially suitable for the transversal cut and it is arranged with an anchor flange to be easily adjusted on fixed or automated hanger. For 24-hours a day trimming SW12SSM is also available in right version (specular) as model SW12SM.



## BLADES Ø 120 MM



12SHSS 12CSW 12DHSS 12SHSSTF 12SHSSTN 12DHSSTN 12SMD

## ACCESSORIES

- Grinders SW1286DIA
- Counterblades SW1081SDIA
- Rail G30-03
- Trailers C30-03, C30-0301
- C30-0302
- Stopper S30-03

- Remote Handles 10SMA
- Butterfly Keys T107500
- Blocking Pins T107600
- Gear Grease T107900
- Metal Gloves GMT-REV









**SILENCE &  
QUALITY**

**3-Phases cutting units**







TEXTILE

TECHNICAL  
TEXTILE

COMPOSITE

# GRT86

## 3-PHASE CUTTING UNITS



### SPECIFICATIONS

- Blade diameter:** 86 mm (3.4"), with hard metal counterblade
- Blade descr.:** 86PHSS, 5-edges, HSS steel
- Blade speed:** 550 r.p.m.
- Cutting ability:** 25 mm (1")
- Motor:** 3-phases asynchronous 380/400\* V, 50 Hz
- Power:** 55 W
- Consumption:** 0.3 A
- Protection:** IP20 – CL F
- Net weight (with power supply cord):** 2650 g
- Total weight (with packaging):** 4750 g
- Electric cable length:** 1.5 mt (with no plug)
- Minimum brightness for working operations:** 200 LUX
- Vibrations at start up:** < 2.5 m/sec 2
- Temperature range:** 0 – 55 C
- Umidity range:** 10 – 95% without condensate

\* This model can be set up at 3-phase 220 V

\* On request: 480 V, 60 Hz

### SAFETY

- Heigh-adjustable trasparent fore blade protection
- Fixed trasparent back blade protection
- CLF - IP20 electric insulation

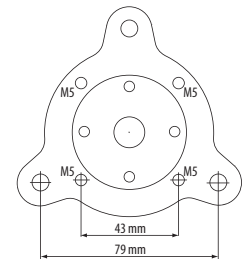

### DESCRIPTION

Model GRT86 is the smallest three-phase cutting unit with carbide counter-blade. For many years within the market it is installed on the main tenting machines. GRT86 is powerfull, small and light (less than 3 Kg.). The 5-edges knife guarantee a clean cut without rag grinding. The semi-utomatic sharpening stone allows the sharpening of the knife edge to be done in less than 10 secons without removing the knife. GRT86 is widely applied in textile, leather, light carpet or technical fabrics field. The three-phase induction motor is balanced and noiseless. This cutting unit does not need any maintenance so to be easily used during the production process on 24 hours-a-day. It is especially suitable for the transversal cut and it arranged with an anchor flange to be easily adjusted on fixed or automated hanger. The base is nylon made and miniaturized so that can be installed on sliding rails within a small space. The minimun maintenance and the minimun handling costs make GRT86 the cheap and reliable cutting solution for any O.E.M. application.

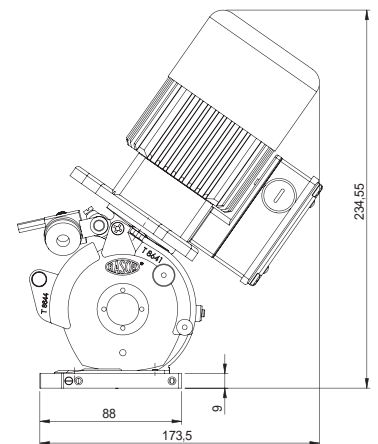

### BLADES Ø 86 MM



86PHSS    86THSS    86PHSSTF    86THSSTF    86THSSTN    86TMD

### ACCESSORIES

- Counterblades SW1081DIA
- Butterfly Keys T107500
- Blocking Pins T107600
- Gear Grease T107900
- Metal Gloves GMT-REV

# GRT86V

## 3-PHASES CUTTING UNITS

TEXTILE

TECHNICAL  
TEXTILE

COMPOSITE

### SPECIFICATIONS

**Blade diameter:** 86 mm (3.4"), with hard metal counterblade

**Blade descr.:** 86PHSS, 5-edges, HSS steel

**Blade speed:** 550 r.p.m.

**Cutting ability:** 25 mm (1")

**Motor:** 3-phases asynchronous 380/400\* V, 50 Hz

**Power:** 55 W

**Consumption:** 0.3 A

**Protection:** IP20 – CLF

**Net weight (with power supply cord):** 2650 g

**Total weight (with packaging):** 4750 g

**Electric cable length:** 1.5 mt (with no plug)

**Minimum brightness for working operations:** 200 LUX

**Vibrations at start up:** < 2.5 m/sec<sup>2</sup>

**Temperature range:** 0 – 55 C

**Umidity range:** 10 – 95% without condensate

\* This model can be set up at 3-phase 220 V

\* On request: 480 V, 60 Hz

### SAFETY

Height-adjustable transparent fore blade protection

Fixed transparent back blade protection

CLF - IP20 electric insulation

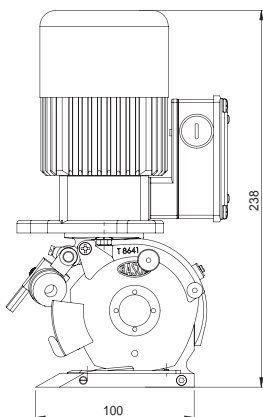
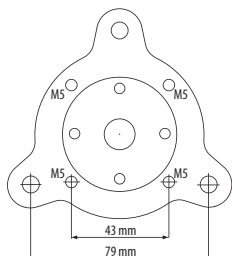

### DESCRIPTION

Model GRT86V is the smallest three-phase cutting unit with carbide counter-blade. For many years within the market it is installed on the main tenting machines. GRT86V is powerful, small and light (less than 3 Kg.). Contrary to all the other Rasor models, GRT86 has a motor installed in vertical position, upright to the cutting direction. The 5-edges knife guarantee a clean cut without rag grinding. The semi-automatic sharpening stone allows the sharpening of the knife edge to be done in less than 10 seconds without removing the knife. GRT86V is widely applied in textile, leather, light carpet or technical fabrics field. The three-phase induction motor is balanced and noiseless. This cutting unit does not need any maintenance so to be easily used during the production process on 24 hours-a-day. It is especially suitable for the transversal cut and it is arranged with an anchor flange to be easily adjusted on fixed or automated hanger. The aluminium miniature base is teflon coated so to reduce the friction with the fabric and to allow an easy installation on sliding rails within a small space. The minimum maintenance and the minimum handling costs make GRT86V the cheap and reliable cutting solution for any O.E.M. application.



### ACCESSORIES

**Counterblades** SW1081DIA

**Butterfly Keys** T107500

**Blocking Pins** T107600

**Gear Grease** T107900

**Metal Gloves** GMT-REV

### BLADES Ø 86 MM



86PHSS

86THSS

86PHSSTF

86THSSTF

86THSSTN

86TMD



TEXTILE

TECHNICAL  
TEXTILE

COMPOSITE

# GRT10

3-PHASES CUTTING UNITS



## SPECIFICATIONS

**Blade diameter:** 100 mm (4"), with hard metal counterblade

**Blade descr.:** 10EHSS, 6-edges, HSS steel

**Blade speed:** 550 r.p.m.

**Cutting ability:** 35 mm (1.4")

**Motor:** 3-phases asynchronous 380/400\* V, 50 Hz

**Power:** 75 W

**Consumption:** 0.36 A

**Protection:** IP20 – CL F

**Net weight (with power supply cord):** 2800 g

**Total weight (with packaging):** 4500 g

**Electric cable length:** 1.5 mt (with no plug)

**Minimum brightness for working operations:** 200 LUX

**Vibrations at start up:** < 2.5 m/sec<sup>2</sup>

**Temperature range:** 0 – 55 C

**Umidity range:** 10 – 95% without condensate

\* This model is also available in left side version (specular) as model **GRT10Sx**

\* This model can be set up at 3-phase 220 V

\* On request: 480 V, 60 Hz

## SAFETY

Height-adjustable transparent fore blade protection

Fixed transparent back blade protection

CLF - IP20 electric insulation



## DESCRIPTION

Model GRT10 is a reliable three-phase cutting unit applied in the textile or technical fabric fields. GRT10 reached the highest level in technology and safety. GRT10 is powerful, reliable and light (less than 3 Kg.). The cutting combination between knife and counterblade guarantee clean cut without rag grinding. The three-phase induction motor is balanced and noiseless. This cutting unit does not need any maintenance so to be easily used during the production process on 24 hours-a-day. The 6-edges 100mm knife allows a cutting thickness up to 35mm. GRT10 is especially suitable for the transversal cut and it arranged with an anchor flange to be easily adjusted on fixed or automated hanger. The aluminium base is teflon coated to avoid any friction with the material and can be installed on sliding rails within a small space. The semi-automatic sharpening stone allows the sharpening of the knife edge to be done in less than 10 seconds without removing the knife. For the stepless trimming process GRT10 is also available in the left hand version (specular) as model GRT10SX. The minimum maintenance and the minimum handling costs make GRT10 the most powerful and reliable cutting solution for any O.E.M. application.

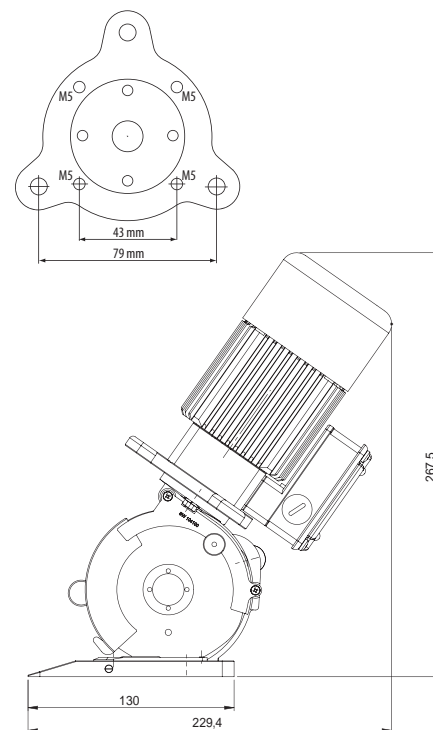

## BLADES Ø 100 MM



## ACCESSORIES

**Grinders** SW1086DIA

**Counterblades** SW1081DIA

**Butterfly Keys** T107500

**Blocking Pins** T107600

**Gear Grease** T107900

**Metal Gloves** GMT-REV

# GRT10SX

## 3-PHASE CUTTING UNITS

TEXTILE

TECHNICAL  
TEXTILE

COMPOSITE

### SPECIFICATIONS

**Blade diameter:** 100 mm (4"), with hard metal counterblade

**Blade descr.:** 10EHSS, 6-edges, HSS steel

**Blade speed:** 550 r.p.m.

**Cutting ability:** 35 mm (1.4")

**Motor:** 3-phases asynchronous 380/400\* V, 50 Hz

**Power:** 75 W

**Consumption:** 0.36 A

**Protection:** IP20 – CLF

**Net weight (with power supply cord):** 2800 g

**Total weight (with packaging):** 4500 g

**Electric cable length:** 1.5 mt (with no plug)

**Minimum brightness for working operations:** 200 LUX

**Vibrations at start up:** < 2.5 m/sec<sup>2</sup>

**Temperature range:** 0 – 55 C

**Umidity range:** 10 – 95% without condensate

\* This model is also available in right side version (specular) as model **GRT10**

\* This model can be set up at 3-phase 220 V

\* On request: 480 V, 60 Hz



### SAFETY

Height-adjustable transparent fore blade protection

Fixed transparent back blade protection

CLF - IP20 electric insulation

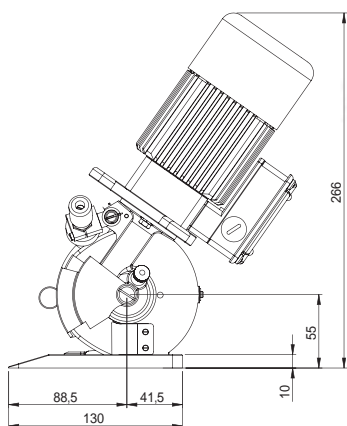
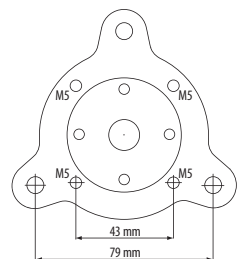

### DESCRIPTION

Model GRT10SX is a reliable three-phase cutting unit applied in the textile or technical fabric fields. GRT10SX reached the highest level in technology and safety. GRT10SX is powerful, reliable and light (less than 3 Kg.). The cutting combination between knife and counter-blade guarantee clean cut without rag grinding. The three-phase induction motor is balanced and noiseless. This cutting unit does not need any maintenance so to be easily used during the production process on 24 hours-a-day. The 6-edges 100mm knife allows a cutting thickness up to 35mm. GRT10SX is especially suitable for the transversal cut and it is arranged with an anchor flange to be easily adjusted on fixed or automated hanger. The aluminium base is teflon coated to avoid any friction with the material and can be installed on sliding rails within a small space. The semi-automatic sharpening stone allows the sharpening of the knife edge to be done in less than 10 seconds without removing the knife. For the stepless trimming process GRT10SX is also available in the right hand version (specular) as model GRT10. The minimum maintenance and the minimum handling costs make GRT10SX the most powerful and reliable cutting solution for any O.E.M. application.



### ACCESSORIES

**Grinders** SW1086DIA

**Counterblades** SW1081SDIA

**Butterfly Keys** T107500

**Blocking Pins** T107600

**Gear Grease** T107900

**Metal Gloves** GMT-REV

### BLADES Ø 100 MM



10EHSS



10CSW



10SEXTG



10EHSSTF



10EMD



TEXTILE

TECHNICAL  
TEXTILE

COMPOSITE

# GRT12

3-PHASE CUTTING UNITS



## SPECIFICATIONS

- Blade diameter:** 120 mm (4.7"), with hard metal counterblade
- Blade descr.:** 12SHSS, 8-edges, HSS steel
- Blade speed:** 400 r.p.m.
- Cutting ability:** 50 mm (2")
- Motor:** 3-phases asynchronous 380/400\* V, 50 Hz
- Power:** 180 W
- Consumption:** 0.52 A
- Protection:** IP20 – CLF
- Net weight (with power supply cord):** 4650 g
- Total weight (with packaging):** 6350 g
- Electric cable length:** 1.5 mt (with no plug)
- Minimum brightness for working operations:** 200 LUX
- Vibrations at start up:** < 2.5 m/sec<sup>2</sup>
- Temperature range:** 0 – 55 C
- Umidity range:** 10 – 95% without condensate

\* This model is also available in left side version (specular) as model **GRT12Sx**

\* This model can be set up at 3-phase 220 V

\* On request: 480 V, 60 Hz

## SAFETY

- High-adjustable transparent fore blade protection
- Fixed transparent back blade protection
- CLF - IP20 electric insulation

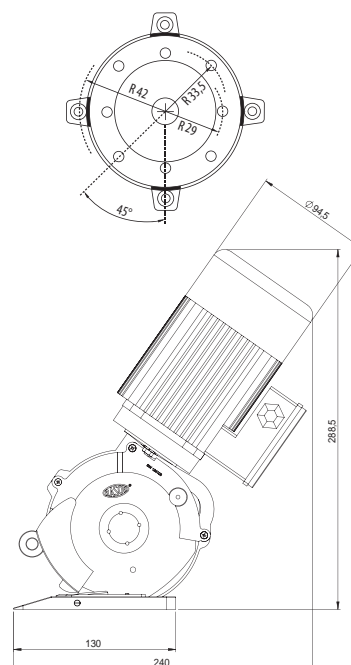

## DESCRIPTION

Model GRT12 is a three-phase cutting unit suitable to cut high thickness in the textile or technical fabric fields. GRT12 reached the highest level in technology and safety. GRT12 is powerful, reliable and light (4Kg only). The cutting combination between knife and counter-blade guarantee clean cut without rag grinding. The three-phase induction motor is balanced and noiseless. This cutting unit does not need any maintenance so to be easily used during the production process on 24 hours-a-day. The 8-edges 120mm knife allows a cutting thickness up to 50mm even for multiple layers. GRT12 is especially suitable for the transversal cut and it arranged with an anchor flange to be easily adjusted on fixed or automated hanger. The aluminium base is teflon coated to avoid any friction with the material and can be installed on sliding rails within a small space. The semi-automatic sharpening stone allows the sharpening of the knife edge to be done in less than 10 seconds without removing the knife. For the stepless trimming process GRT12 is also available in the left hand version (specular) as model GRT12SX. The minimum maintenance and the minimum handling costs make GRT12 the most powerful and reliable cutting solution for any O.E.M. application.



## BLADES Ø 120 MM



12SHSS 12CSW 12DHSS 12SHSSTF 12SHSSTN 12DHSSTN 12SMD

## ACCESSORIES

- Grinders SW1286DIA
- Counterblades SW1081DIA
- Butterfly Keys T107500
- Blocking Pins T107600
- Gear Grease T107900
- Metal Gloves GMT-REV

# GRT12SX

## 3-PHASES CUTTING UNITS

TEXTILE

TECHNICAL  
TEXTILE

COMPOSITE

### SPECIFICATIONS

**Blade diameter:** 120 mm (4.7"), with hard metal counterblade

**Blade descr.:** 12SHSS, 8-edges, HSS steel

**Blade speed:** 400 r.p.m.

**Cutting ability:** 50 mm (2")

**Motor:** 3-phases asynchronous 380/400\* V, 50 Hz

**Power:** 180 W

**Consumption:** 0.52 A

**Protection:** IP20 – CL F

**Net weight (with power supply cord):** 4650 g

**Total weight (with packaging):** 6350 g

**Electric cable length:** 1.5 mt (with no plug)

**Minimum brightness for working operations:** 200 LUX

**Vibrations at start up:** < 2.5 m/sec<sup>2</sup>

**Temperature range:** 0 – 55 C

**Umidity range:** 10 – 95% without condensate

\* This model is also available in right side version (specular) as model **GRT12**

\* This model can be set up at 3-phase 220 V

\* On request: 480 V, 60 Hz

### SAFETY

Height-adjustable transparent fore blade protection

Fixed transparent back blade protection

CLF - IP20 electric insulation

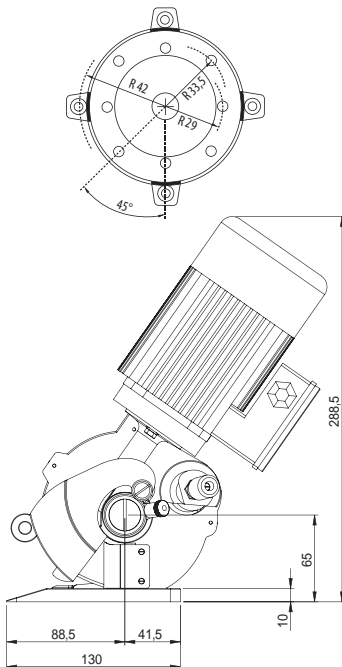

### DESCRIPTION

Model GRT12SX is a three-phase cutting unit suitable to cut high thickness in the textile or technical fabric fields. GRT12SX reached the highest level in technology and safety. GRT12SX is powerful, reliable and light (4Kg only). The cutting combination between knife and counter-blade guarantee clean cut without rag grinding. The three-phase induction motor is balanced and noiseless. This cutting unit does not need any maintenance so to be easily used during the production process on 24 hours-a-day. The 8-edges 120mm knife allows a cutting thickness up to 50mm even for multiple layers. GRT12SX is especially suitable for the transversal cut and it arranged with an anchor flange to be easily adjusted on fixed or automated hanger. The aluminium base is teflon coated to avoid any friction with the material and can be installed on sliding rails within a small space. The semi-automatic sharpening stone allows the sharpening of the knife edge to be done in less than 10 seconds without removing the knife. For the stepless trimming process GRT12SX is also available in the right hand version (specular) as model GRT12. The minimum maintenance and the minimum handling costs make GRT12SX the most powerful and reliable cutting solution for any O.E.M. application.



### ACCESSORIES

**Grinders** SW1286DIA

**Counterblades** SW1081SDIA

**Butterfly Keys** T107500

**Blocking Pins** T107600

**Gear Grease** T107900

**Metal Gloves** GMT-REV

### BLADES Ø 120 MM



12SHSS

12CSW

12DHSS

12SHSSTF

12SHSSTN

12DHSSTN

12SMD



TEXTILE

TECHNICAL  
TEXTILE

COMPOSITE

# GRT12M

## 3-PHASE CUTTING UNITS

### SPECIFICATIONS

- Blade diameter:** 120 mm (4.7"), with hard metal counterblade
- Blade descr.:** 12SHSS, 8-edges, HSS steel
- Blade speed:** 400 r.p.m.
- Cutting ability:** 50 mm (2")
- Motor:** 3-phases asynchronous 380/400\* V, 50 Hz
- Power:** 180 W
- Consumption:** 0.52 A
- Protection:** IP20 – CL F
- Net weight (with power supply cord):** 4600 g
- Total weight (with packaging):** 6300 g
- Electric cable length:** 1.5 mt (with no plug)
- Minimum brightness for working operations:** 200 LUX
- Vibrations at start up:** < 2.5 m/sec<sup>2</sup>
- Temperature range:** 0 – 55 C
- Umidity range:** 10 – 95% without condensate

\* This model is also available in left side version (specular) as model **GRT12SM**

\* This model can be set up at 3-phase 220 V

\* On request: 480 V, 60 Hz

### SAFETY

- High-adjustable transparent fore blade protection
- Fixed transparent back blade protection
- CLF - IP20 electric insulation



### DESCRIPTION

Model GRT12M is a three-phase cutting unit suitable to cut high thickness in the technical fabrics and composite materials. Launched on the market only a couple of months ago GRT12M gives its excellency to the new geometry of the motor housing of Monster series. The difference between GRT12M and the other Rasor's cutting units is given by its motor housing held by a central foot fitted behind the blade in central position. This system spreads the shearing stress and the necessary stress to move the machine through the fabrics on both sides of the cutter and cut is so done perfectly straight and smooth. The knife is half-free on both sides to avoid winding problems even with tough fibers. This is why GRT12M is especially suitable to cut composite materials like glass fiber, carbon fiber and kevlar. The three-phase induction motor is balanced and noiseless. It does not need any maintenance so to be easily used during The production process on 24 hours-a-day. This type of motor together with bronze/steel couplings give the cutting unit to be reliable and resistance in life. The 8-edges 120 mm knife allows a cutting thickness up to 50 mm even for multiple layers. High torque combined with the slow RPM of the knife allow to cut even rubber materials and plastic based material in the field of carpets and industrial flooring. The push button sharpening stone allows the sharpening of the knife edge to be done in less than 10 seconds without removing the knife. The aluminium base is Teflon® coated to reduce friction with the material and can be installed on sliding rails within a small space. GRT12M is especially suitable for the transversal cut and it arranged with an anchor flange to be easily adjusted on fixed or automated hanger. For the stepless trimming process GRT12M is also available in the left side version (specular) as model GRT12SM. The minimum maintenance and the minimum handling costs make GRT12M the most powerful and reliable cutting solution for any O.E.M. application.

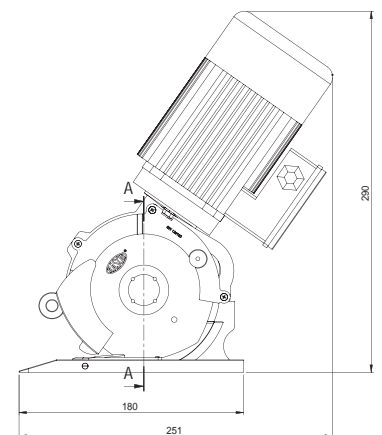
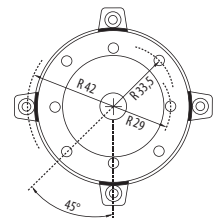

### BLADES Ø 120 MM



### ACCESSORIES

- Grinders SW1286DIA
- Counterblades SW1081DIA
- Butterfly Keys T107500
- Blocking Pins T107600
- Gear Grease T107900
- Metal Gloves GMT-REV

# GRT12SM

## 3-PHASES CUTTING UNITS

### SPECIFICATIONS

**Blade diameter:** 120 mm (4.7"), with hard metal counterblade

**Blade descr.:** 12SHSS, 8-edges, HSS steel

**Blade speed:** 400 r.p.m.

**Cutting ability:** 50 mm (2")

**Motor:** 3-phases asynchronous 380/400\* V, 50 Hz

**Power:** 180 W

**Consumption:** 0.52 A

**Protection:** IP20 – CL F

**Net weight (with power supply cord):** 4600 g

**Total weight (with packaging):** 6300 g

**Electric cable length:** 1.5 mt (with no plug)

**Minimum brightness for working operations:** 200 LUX

**Vibrations at start up:** < 2.5 m/sec<sup>2</sup>

**Temperature range:** 0 – 55 C

**Umidity range:** 10 – 95% without condensate

\* This model is also available in right side version (specular) as model **GRT12M**

\* This model can be set up at 3-phase 220 V

\* On request: 480 V, 60 Hz

### SAFETY

Heigh-adjustable trasparent fore blade protection

Fixed trasparent back blade protection

CLF - IP20 electric insulation

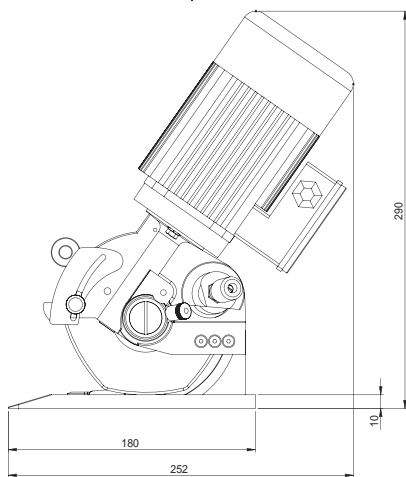
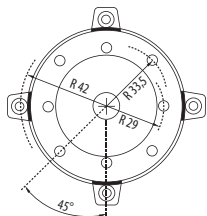

TEXTILE

TECHNICAL  
TEXTILE

COMPOSITE

### DESCRIPTION

Model GRT12SM is a three-phase cutting unit suitable to cut high thickness in the technical fabrics and composite materials. Launched on the market only a couple of months ago GRT12SM gives its excellency to the new geometry of the motor housing of Monster series. The difference between GRT12SM and the other Rasor's cutting units is given by its motor housing held by a central foot fitted behind the blade in central position. This system spreads the shearing stress and the necessary stress to move the machine through the fabrics on both sides of the cutter and cut is so done perfectly straight and smooth. The knife is half-free on both sides to avoid winding problems even with tough fibers. This is why GRT12SM is especially suitable to cut composite materials like glass fiber, carbon fiber and kevlar. The three-phase induction motor is balanced and noiseless. It does not need any maintenance so to be easily used during The production process on 24 hours-a-day. This type of motor together with bronze/steel couplings give the cutting unit to be reliable and resistance in life. The 8-edges 120 mm knife allows a cutting thickness up to 50 mm even for multiple layers. High torque combined with the slow RPM of the knife allow to cut even rubber materials and plastic based material in the field of carpets and industrial flooring. The push button sharpening stone allows the sharpening of the knife edge to be done in less than 10 seconds without removing the knife. The aluminium base is Teflon® coated to reduce friction with the material and can be installed on sliding rails within a small space. GRT12SM is especially suitable for the transversal cut and it arranged with an anchor flange to be easily adjusted on fixed or automated hanger. For the stepless trimming process GRT12SM is also available in the right side version (specular) as model GRT12M. The minimum maintenance and the minimum handling costs make GRT12SM the most powerfull and reliable cutting solution for any O.E.M. application.



### ACCESSORIES

**Grinders** SW1286DIA

**Counterblades** SW1081SDIA

**Butterfly Keys** T107500

**Blocking Pins** T107600

**Gear Grease** T107900

**Metal Gloves** GMT-REV

### BLADES Ø 120 MM



12SHSS

12CSW

12DHSS

12SHSSTF

12SHSSTN

12DHSSTN

12SMD



TEXTILE

TECHNICAL  
TEXTILE

COMPOSITE

# GRT12DT

## 3-PHASE CUTTING UNITS



BI-DIRECTIONAL



### SPECIFICATIONS

- Blade diameter:** 120 mm (4.7"), with double hard metal counterblade
- Blade descr.:** 12SHSS, 8-edges, HSS steel
- Blade speed:** 400 r.p.m.
- Cutting ability:** 50 mm (2"), bidirectional
- Motor:** 3-phases asynchronous 380/400\* V, 50 Hz
- Power:** 180 W
- Consumption:** 0.52 A
- Protection:** IP20 – CL F
- Net weight (with power supply cord):** 4590 g
- Total weight (with packaging):** 6290 g
- Electric cable length:** 1.5 mt (with no plug)
- Minimum brightness for working operations:** 200 LUX
- Vibrations at start up:** < 2.5 m/sec 2
- Temperature range:** 0 – 55 C
- Umidity range:** 10 – 95% without condensate

\* This model can be set up at 3-phase 220 V

\* On request: 480 V, 60 Hz

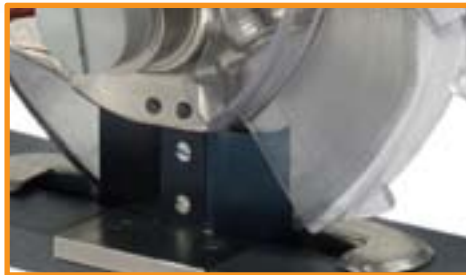

### SAFETY

- Heigh-adjustable trasparent fore blade protection
- Fixed trasparent back blade protection
- CLF - IP20 electric insulation

### DESCRIPTION

GRT12DT is a three-phase cutting unit suitable to cut high thickness in the technical fabric and composite material fields. Thanks to the double carbide counter-blade GRT12DT is able to cut on both directions (through an inverter). This peculiarity allow to save one run and so time in cross-cut process. The three-phase induction motor is balanced and noiseless. It does not need any maintenance so to be easily used for 24 hours-a-day production process. This type of motor together with bronze/steel couplings give the cutting unit to be reliable and resistance in life. The 8-edges 120mm knife allows a cutting thickness up to 50 mm even for multiple layers. High torque combined with the slow RPM of the knife allow to cut even rubber materials and plastic based material in the field of carpets and industrial flooring. The push button sharpening stone allows the sharpening of the knife edge to be done in less than 10 seconds without removing the knife. The aluminium base is Teflon® coated to reduce friction with the material and can be installed on sliding rails within a small space. GRT12DT is especially suitable for the transversal cut and it arranged with an anchor flange to be easily adjusted on fixed or automated hanger. The powerfull and bi-directional cut make GRT12DT the perfect solution for the most complicate O.E.M application.

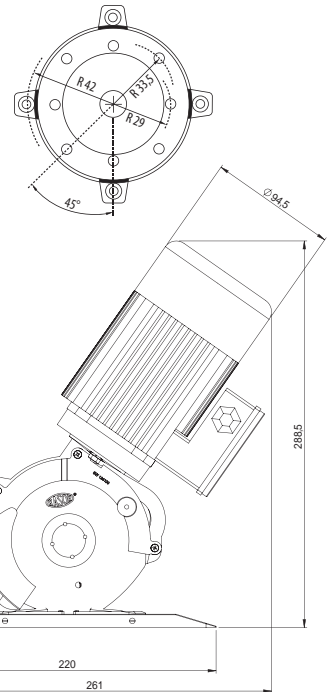

### BLADES Ø 120 MM



12SHSS 12CSW 12DHSS 12SHSSTF 12SHSSTN 12DHSSTN 12SMD

### ACCESSORIES

- Grinders SW1286DIA
- Counterblades SW1081DIA - SW1081SDIA
- Butterfly Keys T107500
- Blocking Pins T107600
- Gear Grease T107900
- Metal Gloves GMT-REV







# **HIGH SPEED CUTTING PROCESS & LOW MAINTENANCE**

**3-Phases DirectDrive cutting units**





TEXTILE

TECHNICAL  
TEXTILE

COMPOSITE

# DD120R

3-PHASES DIRECTDRIVE CUTTING UNITS

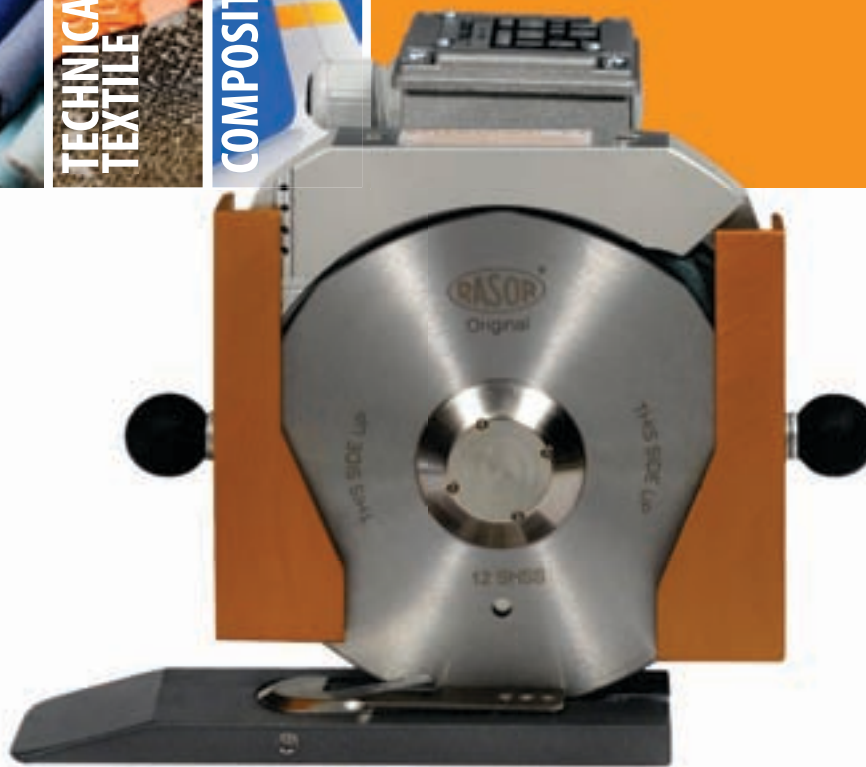

## SPECIFICATIONS

- Blade diameter:** 120 mm (4.7"), with hard metal counterblade
- Blade descr.:** 12SHSS, 8-edges, HSS steel
- Blade speed:** 2600 r.p.m.
- Cutting ability:** 50 mm (2")
- Motor:** 3-phases asynchronous 380/400\* V, 50 Hz
- Power:** 180 W
- Consumption:** 0.52 A
- Protection:** IP20 – CL F
- Net weight (with power supply cord):** 4000 g
- Total weight (with packaging):** 5700 g
- Electric cable length:** 1.5 mt (with no plug)
- Minimum brightness for working operations:** 200 LUX
- Vibrations at start up:** < 2.5 m/sec 2
- Temperature range:** 0 – 55 C
- Umidity range:** 10 – 95% without condensate

\* This model is also available in left side version (specular) as model **DD120L**

\* This model can be set up at 3-phase 220 V

\* On request: 480 V, 60 Hz



## SAFETY

- High-adjustable fore blade protection in anodized aluminium
- High-adjustable back blade protection in anodized aluminium
- CLF - IP20 electric insulation

## DESCRIPTION

Model DD120R is a three-phase cutting unit for cutting textile, technical fabrics and composite material. That is part of the latest technology of Rasor DirectDrive such as the knife installed on the same axis of the motor. DD120R has no coupling gear which means no maintenance (i.e. the lubrication with grease) reducing therefore also the operation cost while using during the no-stop 24h/day production processes. The knife can reach a speed of 2600 RPM so this tool comes perfect for the high speed no-stop cutting process. The cutting system by a knife and counterblade assure a precise and sharp cut without scraps. The induction three-phase motor is balanced and silenced with no maintenance needed assuring reliability for life. The knife is 120 mm diameter 8-edges and allows to reach a cutting thickness of 50 mm even as multi-layers. DD120R is especially studied for the transversal and no-stop cut and it is arranged with an anchor flange easy to be fitted on fixed or automatic stirrup. The aluminium Teflon® coated base reduce the friction between the foot and the material and allow the easy forward movement even for an installation sliding rails. The push button sharpening stone allows the sharpening of the knife edge to be done in less than 10 seconds without removing the knife. For the no-stop trimming process DD120R is also available in left version (specular) as model DD120L. The minimum needed maintenance and low production cost make DD120R to be a reliable cutting solution in any high speed O.E.M. application.

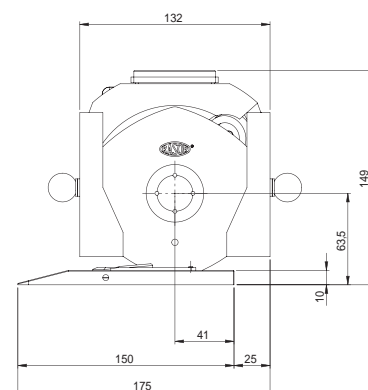

## BLADES Ø 120 MM



## ACCESSORIES

- Grinders** SW1286DIA
- Counterblades** SW1081DIA
- Butterfly Keys** T107500
- Metal Gloves** GMT-REV
- Rail** G30-03
- Trailers** C30-03
- Stopper** S30-03
- Remote Handles** 10SMADD

# DD120L

## 3-PHASES DIRECTDRIVE CUTTING UNITS



### SPECIFICATIONS

- Blade diameter:** 120 mm (4.7"), with hard metal counterblade
- Blade descr.:** 12SHSS, 8-edges, HSS steel
- Blade speed:** 2600 r.p.m.
- Cutting ability:** 50 mm (2")
- Motor:** 3-phases asynchronous 380/400\* V, 50 Hz
- Power:** 180 W
- Consumption:** 0.52 A
- Protection:** IP20 – CL F
- Net weight (with power supply cord):** 4000 g
- Total weight (with packaging):** 5700 g
- Electric cable length:** 1.5 mt (with no plug)
- Minimum brightness for working operations:** 200 LUX
- Vibrations at start up:** < 2.5 m/sec<sup>2</sup>
- Temperature range:** 0 – 55 C
- Umidity range:** 10 – 95% without condensate

\* This model is also available in right side version (specular) as model **DD120R**

\* This model can be set up at 3-phase 220 V

\* On request: 480 V, 60 Hz

### SAFETY

- Heigh-adjustable fore blade protection in anodized aluminium
- Heigh-adjustable back blade protection in anodized aluminium
- CLF - IP20 electric insulation

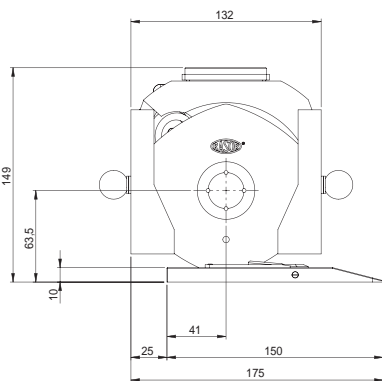

### DESCRIPTION

Model DD120L is a three-phase cutting unit for cutting textile, technical fabrics and composite material. That is part of the latest technology of Razor DirectDrive such as the knife installed on the same axis of the motor. DD120L has no coupling gear which means no maintenance (i.e. the lubrication with grease) reducing therefore also the operation cost while using during the no-stop 24h/day production processes. The knife can reach a speed of 2600 RPM so this tool comes perfect for the high speed no-stop cutting process. The cutting system by a knife and counterblade assure a precise and sharp cut without scraps. The induction three-phase motor is balanced and silenced with no maintenance needed assuring reliability for life. The knife is 120 mm diameter 8-edges and allows to reach a cutting thickness of 50 mm even as multi-layers. DD120L is especially studied for the transversal and no-stop cut and it is arranged with a anchor flange easy to be fitted on fixed or automatic stirrup. The aluminium Teflon® coated base reduce the friction between the foot and the material and allow the easy forward movement even for an installation sliding rails. The push button sharpening stone allows the sharpening of the knife edge to be done in less than 10 seconds without removing the knife. For the no-stop trimming process DD120L is also available in right version (specular) as model DD120R. The minimum needed maintenance and low production cost make DD120L to be a reliable cutting solution in any high speed O.E.M. application.



### ACCESSORIES

- Grinders** SW1286DIA
- Counterblades** SW1081SDIA
- Butterfly Keys** T107500
- Metal Gloves** GMT-REV
- Rail** G30-03
- Trailers** C30-03
- Stopper** S30-03
- Remote Handles** 10SMADD

### BLADES Ø 120 MM



12SHSS

12CSW

12DHSS

12SHSSTF

12SHSSTN

12DHSSTN

12SMD



TEXTILE

TECHNICAL  
TEXTILE

COMPOSITE

# DD120RC

3-PHASES DIRECTDRIVE CUTTING UNITS



## SPECIFICATIONS

- Blade diameter:** 120 mm (4.7")
- Blade descr.:** 12CSW, circular, EXTRA steel
- Blade speed:** 2600 r.p.m.
- Cutting ability:** 50 mm (2")
- Motor:** 3-phases asynchronous 380/400\* V, 50 Hz
- Power:** 180 W
- Consumption:** 0.52 A
- Protection:** IP20 – CL F
- Net weight (with power supply cord):** 4000 g
- Total weight (with packaging):** 5700 g
- Electric cable length:** 1.5 mt (with no plug)
- Minimum brightness for working operations:** 200 LUX
- Vibrations at start up:** < 2.5 m/sec<sup>2</sup>
- Temperature range:** 0 – 55 C
- Umidity range:** 10 – 95% without condensate

\* This model is also available in left side version (specular) as model **DD120LC**

\* This model can be set up at 3-phase 220 V

\* On request: 480 V, 60 Hz



## SAFETY

- High-adjustable fore blade protection in anodized aluminium
- High-adjustable back blade protection in anodized aluminium
- CLF - IP20 electric insulation

## DESCRIPTION

Model DD120RC is a three-phase cutting unit for cutting textile, especially natural fiber, mattress or sponge, during production process. That is part of the latest technology of Rasor DirectDrive such as the knife installed on the same axis of the motor. DD120RC has no coupling gear which means no maintenance (i.e. the lubrication with grease) reducing therefore also the operation cost while using during the no-stop 24h/day production process. The knife can reach a speed of 2600 RPM so this tool comes perfect for the high speed no-stop cutting process. The induction three-phase motor is balanced and silenced with no maintenance needed assuring reliability for life. The knife is 120 mm diameter 8-edges and allows to reach a cutting thickness of 50 mm even as multi-layers. DD120RC is especially studied for the transversal and no-stop cut and it is arranged with a anchor flange easy to be fitted on fixed or automatic stirrup. The aluminium Teflon® coated base reduce the friction between the foot and the material and allow the easy forward movement even for an installation sliding rails. The push button sharpening stone allows the sharpening of the knife edge to be done in less than 10 seconds without removing the knife. For the no-stop trimming process DD120RC is also available in left version (specular) as model DD120LC. The minimum needed maintenance and low production cost make DD120RC to be a reliable cutting solution in any high speed O.E.M. application.

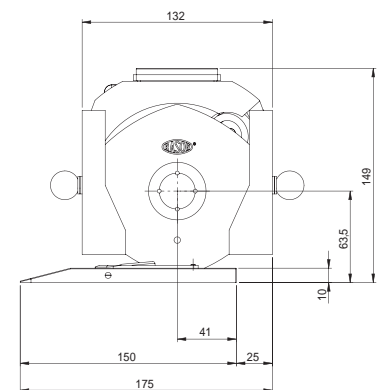

## BLADES Ø 120 MM



12CSW

## ACCESSORIES

- Butterfly Keys** T107500
- Metal Gloves** GMT-REV
- Rail** G30-03
- Trailers** C30-03
- Stopper** S30-03
- Remote Handles** 10SMADD

# DD120LC

## 3-PHASES DIRECTDRIVE CUTTING UNITS

TEXTILE

TECHNICAL  
TEXTILE

COMPOSITE

### SPECIFICATIONS

**Blade diameter:** 120 mm (4.7")

**Blade descr.:** 12CSW, circular, EXTRA steel

**Blade speed:** 2600 r.p.m.

**Cutting ability:** 50 mm (2")

**Motor:** 3-phases asynchronous 380/400\* V, 50 Hz

**Power:** 180 W

**Consumption:** 0.52 A

**Protection:** IP20 – CLF

**Net weight (with power supply cord):** 4000 g

**Total weight (with packaging):** 5700 g

**Electric cable length:** 1.5 mt (with no plug)

**Minimum brightness for working operations:** 200 LUX

**Vibrations at start up:** < 2.5 m/sec<sup>2</sup>

**Temperature range:** 0 – 55 C

**Umidity range:** 10 – 95% without condensate

\* This model is also available in right side version (specular) as model **DD120RC**

\* This model can be set up at 3-phase 220 V

\* On request: 480 V, 60 Hz



### SAFETY

Height-adjustable fore blade protection in anodized aluminium

Height-adjustable back blade protection in anodized aluminium

CLF - IP20 electric insulation



### DESCRIPTION

Model DD120LC is a three-phase cutting unit for cutting textile, especially natural fiber, mattress or sponge, during production process. That is part of the latest technology of Rasor DirectDrive such as the knife installed on the same axis of the motor. DD120LC has no coupling gear which means no maintenance (i.e. the lubrication with grease) reducing therefore also the operation cost while using during the no-stop 24h/day production process. The knife can reach a speed of 2600 RPM so this tool comes perfect for the high speed no-stop cutting process. The induction three-phase motor is balanced and silenced with no maintenance needed assuring reliability for life. The knife is 120 mm diameter 8-edges and allows to reach a cutting thickness of 50 mm even as multi-layers. DD120LC is especially studied for the transversal and no-stop cut and it is arranged with an anchor flange easy to be fitted on fixed or automatic stirrup. The aluminium Teflon® coated base reduce the friction between the foot and the material and allow the easy forward movement even for an installation sliding rails. The push button sharpening stone allows the sharpening of the knife edge to be done in less than 10 seconds without removing the knife. For the no-stop trimming process DD120LC is also available in right version (specular) as model DD120RC. The minimum needed maintenance and low production cost make DD120LC to be a reliable cutting solution in any high speed O.E.M. application.

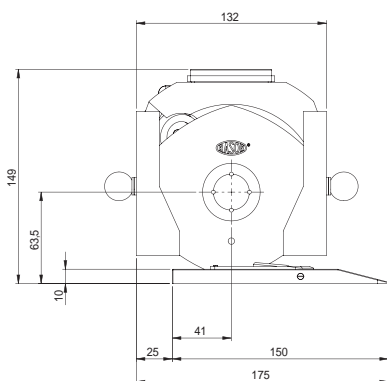

### ACCESSORIES

**Butterfly Keys** T107500

**Metal Gloves** GMT-REV

**Rail** G30-03

**Trailers** C30-03

**Stopper** S30-03

**Remote Handles** 10SMADD

### BLADES Ø 120 MM



12CSW



TEXTILE

TECHNICAL  
TEXTILE

COMPOSITE

# DD120DT

3-PHASES DIRECTDRIVE CUTTING UNITS



BI-DIRECTIONAL

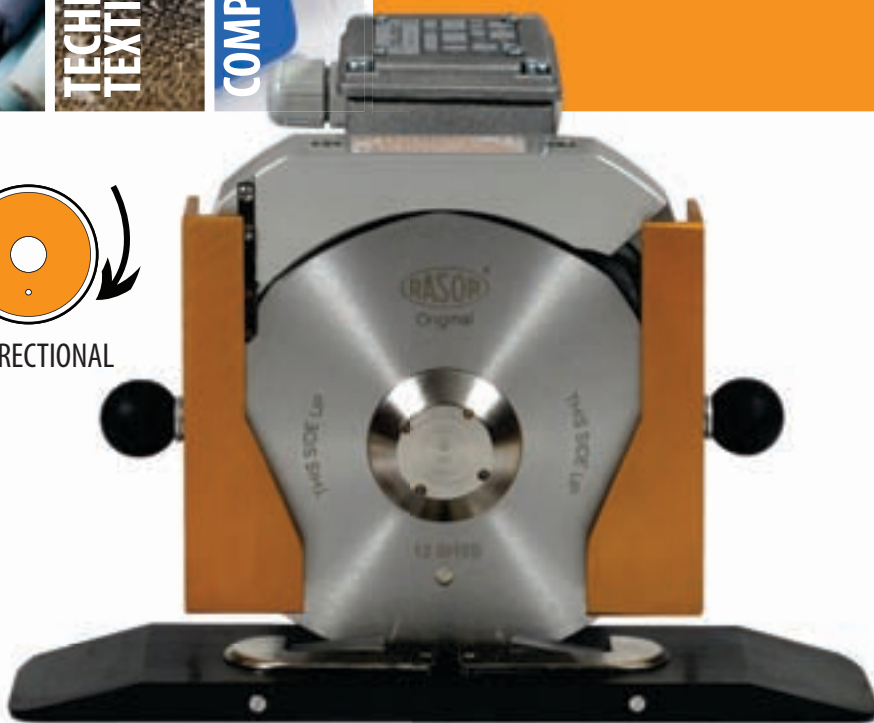

## SPECIFICATIONS

- Blade diameter:** 120 mm (4.7"), with double hard metal counterblade
- Blade descr.:** 12SHSS, 8-edges, HSS steel
- Blade speed:** 2600 r.p.m.
- Cutting ability:** 50 mm (2"), bidirectional
- Motor:** 3-phases asynchronous 380/400\* V, 50 Hz
- Power:** 180 W
- Consumption:** 0.52 A
- Protection:** IP20 – CL F
- Net weight (with power supply cord):** 4150 g
- Total weight (with packaging):** 5850 g
- Electric cable length:** 1.5 mt (with no plug)
- Minimum brightness for working operations:** 200 LUX
- Vibrations at start up:** < 2.5 m/sec<sup>2</sup>
- Temperature range:** 0 – 55 C
- Umidity range:** 10 – 95% without condensate

\* This model can be set up at 3-phase 220 V

\* On request: 480 V, 60 Hz



## SAFETY

- High-adjustable fore blade protection in anodized aluminium
- High-adjustable back blade protection in anodized aluminium
- CLF - IP20 electric insulation

## DESCRIPTION

Model DD120DT is a three-phase cutting unit for textile, technical fabrics and composite material. Thanks to the double carbide counter-blade DD120DT is able to cut on both directions (through an inverter). This peculiarity allow to save one run and so time in cross-cut process. DD120DT is part of new technology of Razor Direct Drive range which see the knife installed on the same axis of the motor. DD120DT has no coupling gear which means no maintenance (i.e. the lubrication with grease) reducing therefore the operation cost. The knife can reach a speed of 2600 RPM so this tool comes perfect to work at very high speed during no-stop 24h/day cutting process. The combination of knife and counterblade assure a precise and sharp cut without scraps. The induction three-phase motor is balanced and silenced requiring no maintenance while assuring reliability for life. The 8-edges 120 mm knife allows a cutting thickness up to 50 mm even for multiple layers. DD120DT is especially designed for the transversal and no-stop cut and it is arranged with a anchor flange easy to be fitted on fixed or automatic stirrup. The base of DD120DT is Teflon® coated to reduce friction with the material and can be installed on sliding rails within a small space. The push button sharpening stone allows the sharpening of the knife edge to be done in less than 10 seconds without removing the knife. The limited maintenance, the low production cost and the bi-directional function make DD120DT the best reliable solution for any high speed O.E.M. application.

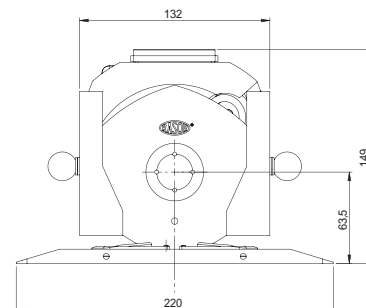

## BLADES Ø 120 MM



12SHSS 12CSW 12DHSS 12SHSSTF 12SHSSTN 12DHSSTN 12SMD

## ACCESSORIES

- Grinders** SW1286DIA
- Counterblades** SW1081DIA
- SW1081SDIA
- Butterfly Keys** T107500
- Metal Gloves** GMT-REV
- Rail** G30-03
- Trailers** C30-0302
- Stopper** S30-03
- Remote Handles** 10SMADD

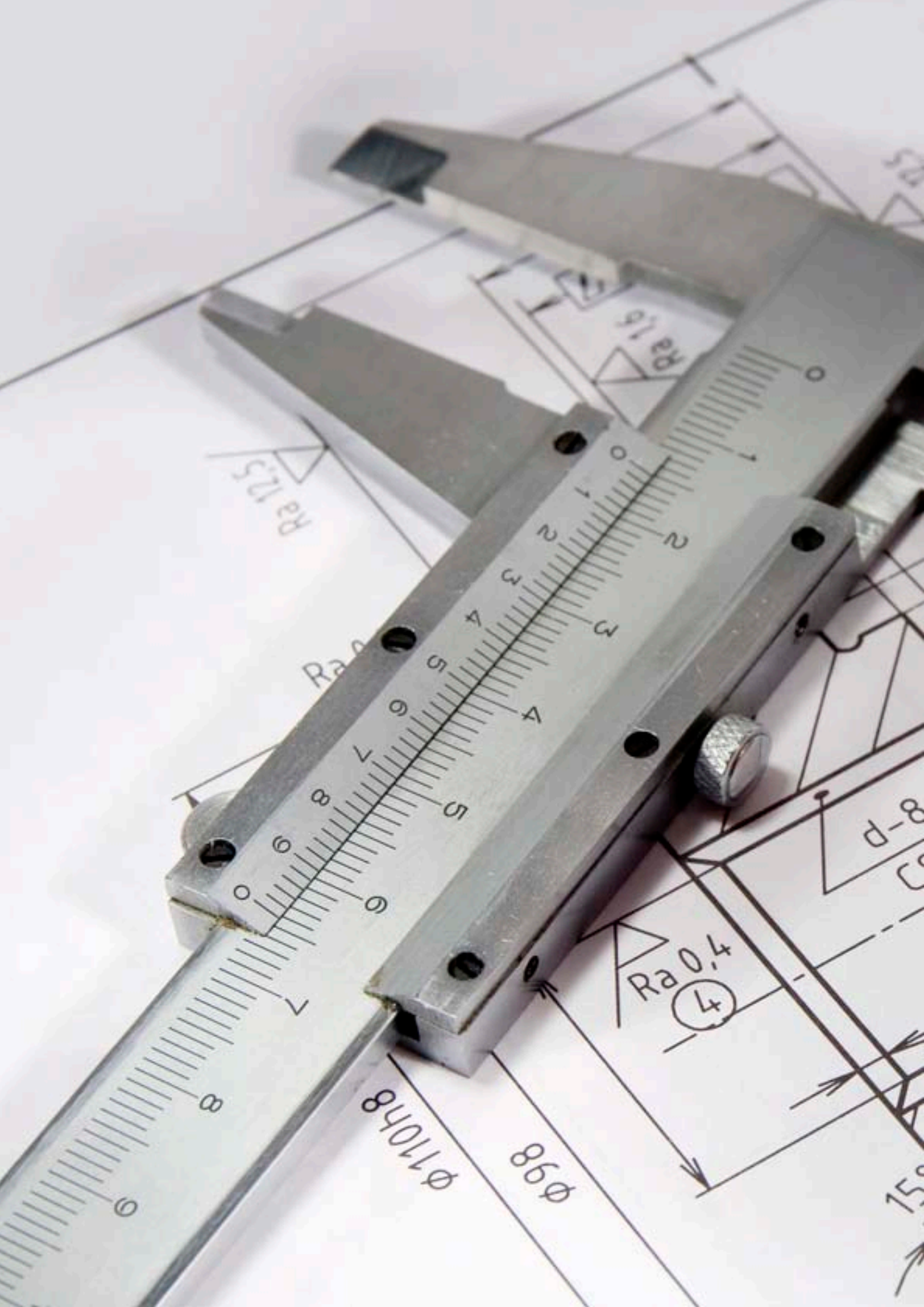

ø110h8

ø98

Ra 0.4

Ra 12.5

Ra 1.6

Ra 0.4

ø8-D

ø51



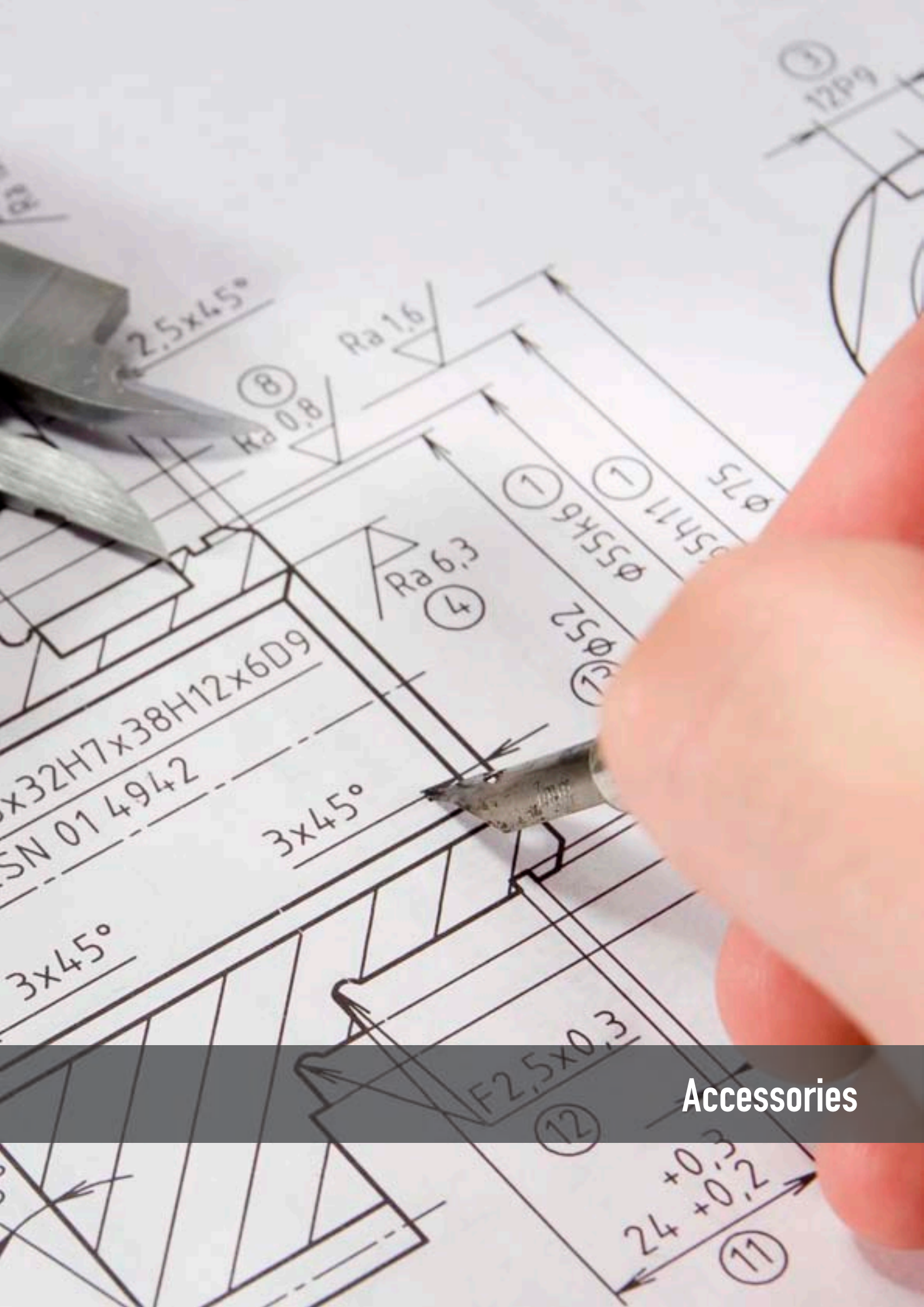

Accessories

# BLADES & MODELS

		Battery Driven Scissors			Electric Hand Shears			Pneumatic Hand Shears						Electric Bench Cutters					
		Zero702	DS503	DS503MT	OPTIMA 702	FP503	FP503MT	FP70	FP861	FP861MT	FP861RC	D86	D86P	D100	SW100	SW12	SW12M		
Blades Ø 50 mm	50SEXT			•					•										
	50SEXTG			•					•										
	50SHSS			•					•										
	50SGHSS			•					•										
	50CHSS			•					•										
	50CK			•					•										
	50SHSSTF			•					•										
	503EEXT								•										
	503EHSS			•					•										
	503CHSS			•					•										
	503DHSS			•					•										
503EHSSTF			•					•											
503DHSSTF			•					•											
Blades Ø 70 mm	70SHSS	•				•													
	70EHSS	•				•													
	70SHSSTF	•				•													
	70EHSSTF	•				•													
	70DHSS	•				•													
	70CHSS	•				•													
	70EMD	•				•													
Blades Ø 86 mm	86CEXT																		
	86CHSS																		
	86PHSS																		
	86THSS																		
	86THSSTF																		
	86THSSTN																		
	86PHSSTF																		
	86TMD																		
Blades Ø 100 mm	10CEXTG																		
	10CGHSS																		
	10CSW																		
	10EHSS																		
	10EHSSTF																		
	10SEXTG																		
	10CFR																		
Blades Ø 120 mm	10EMD																		
	120CF	ONLY FOR SPECIAL APPLICATIONS																	
Blades Ø 200 mm	12CSW																		
	12DHSS																		
	12DHSSTN																		
	12SHSS																		
	12SHSSTF																		
	12SHSSTN																		
	12SMD																		
K200	ONLY FOR SPECIAL APPLICATIONS																		
K200HSS	ONLY FOR SPECIAL APPLICATIONS																		
K200INOX	ONLY FOR SPECIAL APPLICATIONS																		





# BLADES

## BLADES Ø 50 MM



503EHSSTF

503DHSSTF

503DHSS

503CHSS

503EHSS

503EEXT

## BLADES Ø 70 MM



70EMD

70EHSSTF

70SHSSTF

70DHSS

70CHSS

## BLADES Ø 86 MM



86TMD

86THSSTN

86PHSSTF

86THSSTF

86THSS

## BLADES Ø 100 MM



10EMD

10CFR

10SEXTG

10EHSSTF

10EHSS

## BLADES Ø 120 MM

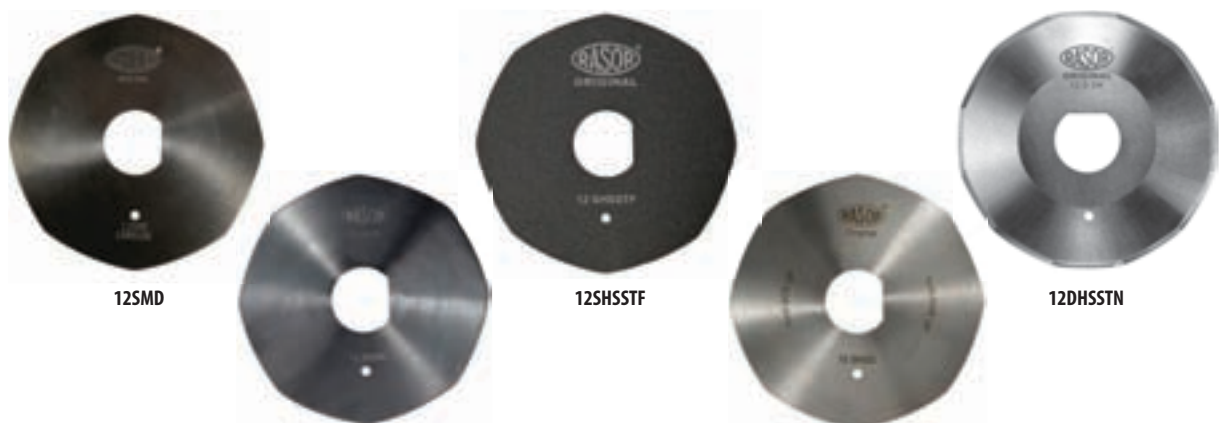

12SMD

12SHSSTN

12SHSSTF

12SHSS

12DHSSTN





50SHSSTF



50CK

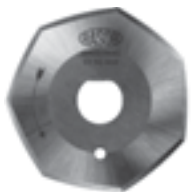

50SGHSS

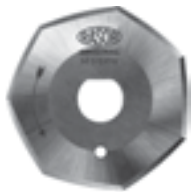

50SEXTG



50CHSS



50SHSS



50SEXT



70EHSS



70SHSS



86PHSS



86CHSS



86CEXT



10CSW



10CGHSS



10CEXTG

**BLADES Ø 200 MM**



12DHSS



12CSW



12OCF



K200



K200 HSS



K200 INOX

# ACCESSORIES & MODELS

		Battery Driven Scissors			Electric Hand Shears			Pneumatic Hand Shears						Electric Bench Cutters					
		Zero702	DS503	DS503MT	OPTIMA 702	FP503	FP503MT	FP70	FP861	FP861MT	FP861RC	D86	D86P	D100	SW100	SW12	SW12M		
Blades Accessories	T107500																		
	F5059	•	•	•	•	•	•					•	•	•	•	•	•		
	T107600																		
Diamond kit	F5057	•	•	•	•														
	SW1286DIA															•	•		
	SW1086DIA	•			•			•	•	•	•								
Battery Driven Machine Accessories	SW1081DIA													•	•	•			
	SW1081SDIA																		
	BAT18	•																	
Special foots	CH01	•																	
	CH02	•																	
Remote handles	F5070A		•					•											
	10SMADD																		
	10SMA																		
Rail Systems	70SMA		•		•														
	C30-03																		
	C30-0301																		
	C30-0302																		
	G30-03																		
	S30-03																		
	C30-04	•	•		•	•		•	•										
	C30-0401	•	•		•	•		•	•										
	C30-0402	•	•		•	•		•	•										
	G30-04	•	•		•	•		•	•										
	S30-04	•	•		•	•		•	•										
	Lubricants	T107900	•	•	•	•	•	•	•	•	•	•	•	•	•	•	•	•	
		T107901	•	•	•	•	•	•	•	•	•	•	•	•	•	•	•	•	
	Safety Device	GMT-REV	•	•	•	•	•	•	•	•	•	•	•	•	•	•	•	•	
		P168																	
Pneumatic Accessories	T107902																		
	T107903																		
	P170																		
	P171																		
	P173																		
	P029																		





# ACCESSORIES

## BLADES ACCESSORIES

### BUTTERFLY KEYS



T107500



F5059

### BLOCKING PINS



T107600



F5057

## DIAMOND KIT

### GRINDERS



SW1286DIA



SW1086DIA

### COUNTERBLADES



SW1081DIA



SW1081SDIA

## BATTERY DRIVEN MACHINE ACCESSORIES

### BATTERIES



BAT18

### CHARGERS



CH01



CH02

## SPECIAL FOOTS



F5070A

## REMOTE HANDLES



10SMADD & 10SMA



70SMA



## RAIL SYSTEMS

### W1040 SERIES



C30-03



C30-0301



C30-0302



G30-03



S30-03

### W0630 SERIES



C30-04



C30-0401



C30-0402



G30-04



S30-04

## LUBRICANTS

### GEAR GREASE



T107900

### SPRAY LUBRICANTS



T107901

## SAFETY DEVICE

### METAL GLOVES



GMT-REV

## PNEUMATIC ACCESSORIES

### REGULATORS



P168

### LUBRICANTS



T107902



T107903

### FAST CONNECTORS



P170



P171

### TUBE



P173

### SILENCERS



P029

# DEALERS



## EUROPE

Austria  
Belgium  
Bosnia Herzegovina  
Denmark  
Estonia  
Finland  
France  
Germany  
Greece  
Latvia  
Lithuania  
Luxemburg  
Netherland  
Norway  
Poland  
Portugal  
Romania  
Spain  
Sweden  
Switzerland  
United Kingdom

## ASIA

China  
Hong Kong  
Indonesia  
Iran  
Japan  
Macau  
Qatar  
Russia  
South Korea  
Taiwan  
UAE

## AMERICAS

Canada  
Mexico  
Unites States

## AFRICA

South Africa



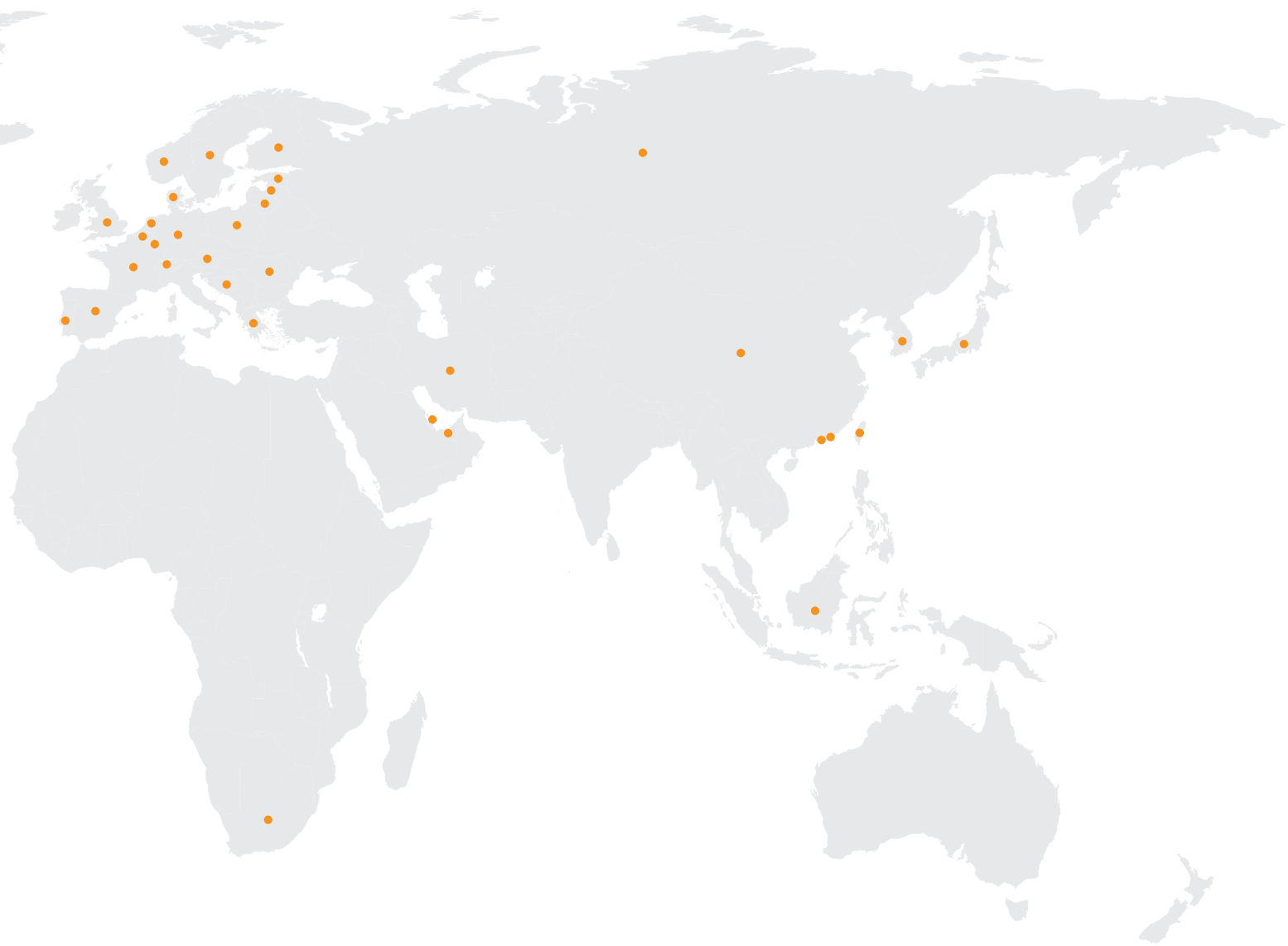

# NOTES

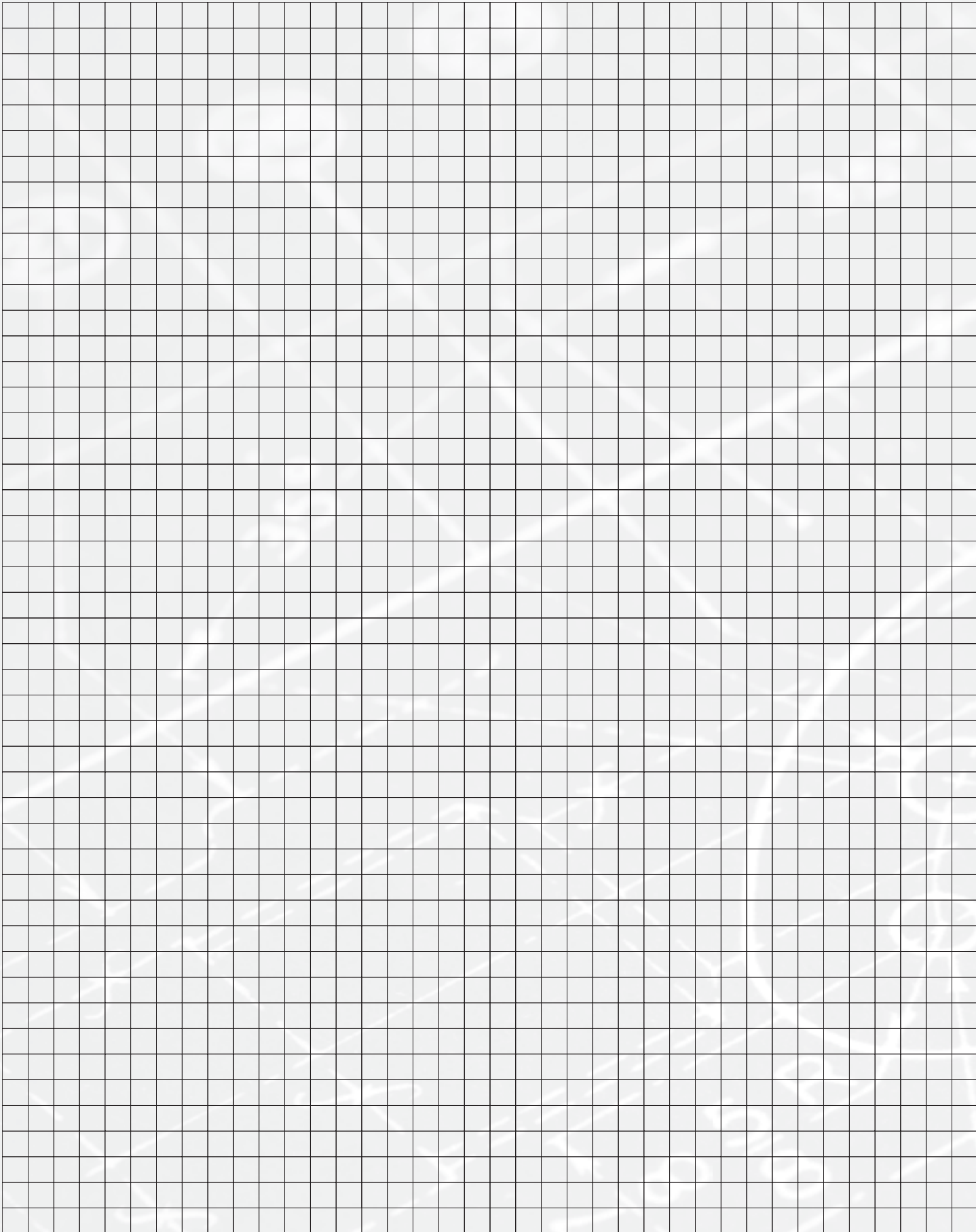





# NOTES

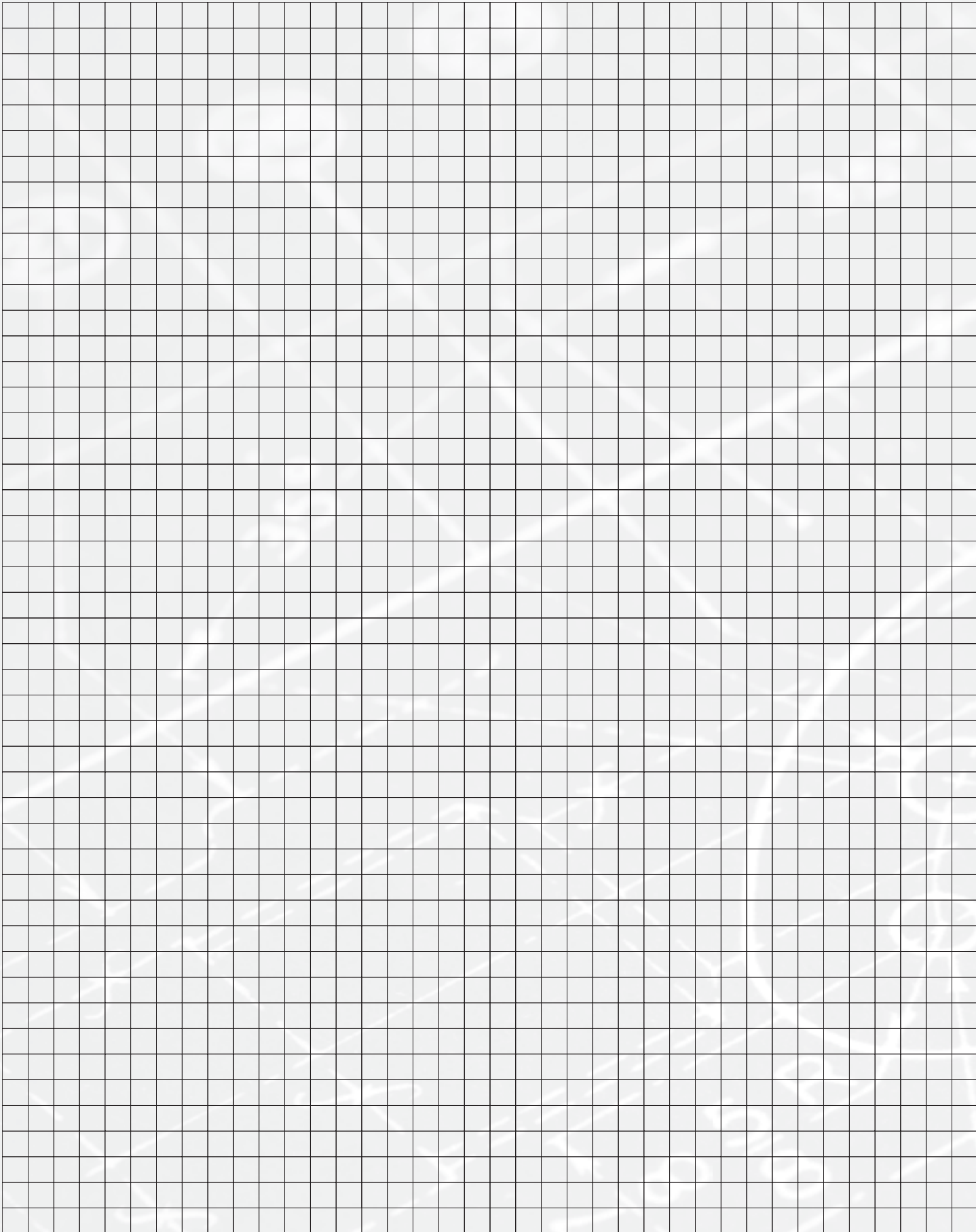







Enrico

Luigi Paolo

Federico

Luigi Scialli





